

220-1101 Dumps

CompTIA A+ Certification Exam: Core 1

<https://www.certleader.com/220-1101-dumps.html>



NEW QUESTION 1

A technician is troubleshooting an old desktop system that randomly shows a Windows BSOD or powers off unexpectedly. All system temperatures are within normal limits. Which of the following should the technician do NEXT?

- A. Visually inspect the motherboard capacitors.
- B. Verify all case fans are operational.
- C. Check that the BIOS version supports the installed CPU.
- D. Compare the software requirements with the installed RAM.

Answer: A

Explanation:

BSODs can be caused by poorly written device drivers or malfunctioning hardware, such as faulty memory, power supply issues, overheating of components, or hardware running beyond its specification limits. In the Windows 9x era, incompatible DLLs or bugs in the operating system kernel could also cause BSODs.

NEW QUESTION 2

A technician powers on a PC and its monitor and sees the following error message: No input signal detected
The display lights on the computer are on. Which of the following is a possible solution?

- A. Changing the BIOS settings
- B. Changing the connector setting on the monitor
- C. Checking the power plug on the monitor
- D. Checking the power plug on the PC

Answer: B

NEW QUESTION 3

A user reports a cell phone is getting hot. Which of the following are MOST likely to be possible causes? (Select THREE).

- A. Using the device as a Wi-Fi hotspot
- B. A cracked screen
- C. A failing battery
- D. Less than 15% free storage space on the phone
- E. Privileged control
- F. Recurring prompts to install OS updates
- G. Granting too many application camera permissions
- H. Too many open applications

Answer: ACH

NEW QUESTION 4

A user wants a second monitor installed on a laptop. The VGA/DVI or HDMI cables have already been connected. Which of the following should the technician do to configure the laptop to show both screens?

- A. Power cycle the laptop.
- B. Plug in the monitor to the USB port.
- C. Adjust the monitor display settings.
- D. Power cycle the monitor.

Answer: C

NEW QUESTION 5

A technician is tasked with installing additional RAM in a desktop computer. Which of the following types of RAM is MOST likely to be used?

- A. SODIMM
- B. DDR3
- C. ECC
- D. VRAM

Answer: B

NEW QUESTION 6

An end user discovered that the touch-screen features on a Windows device have stopped working. Which of the following should a technician check?

- A. Performance monitor
- B. Tablet/PC settings
- C. System configuration
- D. Display settings

Answer: D

NEW QUESTION 7

Which of the following types of devices MOST often uses a Thunderbolt cable?

- A. Linux PC
- B. Android mobile
- C. Apple laptop
- D. Chromebook

Answer: C

Explanation:

CompTIA study guide says Apple Devices use thunderbolt and lightning cables the most, but it is being implemented in Windows and Linux products.

NEW QUESTION 8

A technician is commissioning a workstation that is required to have mirrored storage, utilizing two 4TB drives that support one failure. Which of the following BEST meets these requirements?

- A. RAID 0
- B. RAID 1
- C. RAID 5
- D. RAID 10

Answer: B

NEW QUESTION 9

Recently, an organization received a number of spam emails that passed through the spam gateway. The emails contained generally the same information, but the sending domains were different. Which of the following solutions would BEST help mitigate the issue?

- A. Updating the keyword filtering
- B. Editing the sender policy framework
- C. Contacting the gateway vendor
- D. Verifying DMARC is enabled

Answer: D

Explanation:

DMARC (Domain-based Message Authentication, Reporting and Conformance) is an email authentication protocol. It is designed to give email domain owners the ability to protect their domain from unauthorized use, commonly known as email spoofing.

NEW QUESTION 10

An administrator is configuring a corporate-owned smartphone for a new manager. The company requires the ability to wipe the phone's data remotely in the event of loss or theft and the capability to approve applications installed on the phone. Which of the following tools would BEST meet this need?

- A. Tethering to a corporate-owned laptop
- B. WPA2-Enterprise wireless
- C. Corporate enterprise email
- D. Mobile device management

Answer: D

NEW QUESTION 10

A technician is receiving reports that the entire office sporadically loses network connectivity throughout the day. The technician determines the root cause to be EMI. Which of the cable mediums would be the MOST cost effective without sacrificing system performance?

- A. Coaxial
- B. Shielded Cat 6
- C. Plenum Cat 5e
- D. Multimode fiber

Answer: B

Explanation:

Electromagnetic interference (EMI) is unwanted noise or interference in an electrical path or circuit caused by an outside source. Hence shielded Cat 6 is better

NEW QUESTION 13

A technician is implementing a SOHO wireless solution with three access points. Which of the following actions would avoid high latency?

- A. Enabling and configuring a 5GHz antenna
- B. Configuring separate IP ranges
- C. Enabling multiple SSIDs
- D. Configuring all devices with different channels

Answer: B

NEW QUESTION 16

The Chief Executive Officer wants to ensure company data is stored in a manner that provides the company with complete control over how the data is managed. Which of the following is the BEST cloud deployment model for this request?

- A. Community

- B. Hybrid
- C. Public
- D. Private

Answer: D

NEW QUESTION 18

A user reports issues with a smartphone after dropping it. The icons on the screen all look normal, but when the user touches the email icon, for example, nothing happens. Which of the following is MOST likely the cause?

- A. Digitizer issues
- B. Overheating
- C. Broken screen
- D. Malware

Answer: A

NEW QUESTION 20

A customer is using a satellite internet connection that is experiencing slowness. A technician notices high latency while pinging, but the download test is performing perfectly with very good download speeds. Which of the following represents the NEXT action the technician should perform?

- A. Restart the modem and run an online internet connection and speed diagnostic tool.
- B. Guide the customer on how to upgrade the internet plan with the provider in order to improve latency.
- C. Explain to the customer this is not an issue; this situation is normal for this type of internet connection.
- D. Replace the modem because it is not working correctly based on the test result.

Answer: A

NEW QUESTION 25

A technician is monitoring all outbound traffic in a SOHO. Which of the following is the MOST cost-effective solution to monitor the traffic?

- A. Spectrum analyzer
- B. Network tap
- C. Lookback plug
- D. Toner probe

Answer: B

NEW QUESTION 26

A user brings an older laptop to the help desk and reports issues with the keyboard. Upon inspection, the technician does not see any external damage but notices that many keystrokes do not register in a word processor. The laptop works fine when the technician tests it with an external keyboard. Which of the following actions would MOST likely resolve the issue?

- A. Disable the sticky keys feature.
- B. Clean the keyboard.
- C. Reset the BIOS settings to default.
- D. Charge the laptop.

Answer: C

NEW QUESTION 27

While implementing a non-carrier-grade wireless backhaul, a technician notices the current channel selection is externally polluted with various RF signals. Upon performing a spectral analysis, the technician discovers a channel containing almost no RF pollution. Unfortunately, the technician is unable to select that channel. Which of the following is the MOST likely reason for this issue?

- A. The channel is reserved for licensed band use.
- B. The channel selection is defective, contact the manufacturer.
- C. The channel must be unblocked by the vendor.
- D. The device requires a firmware update to unlock the channel.

Answer: A

Explanation:

The 2.4 GHz band is subdivided into up to 14 channels, spaced at 5 MHz intervals from 2412 MHz up to 2484 MHz. Wi-Fi requires bandwidth of approximately 20 MHz, not 5 MHz. Consequently, a site designer needs to choose the channels that do not overlap. On a WLAN where only the first 11 channels are available, channels 1, 6, and 11 can be selected as non-overlapping. Note: In the Americas, regulations permit the use of channels 1-11 only, while in Europe, channels 1-13 are permitted. In Japan, all 14 channels are permitted.

NEW QUESTION 32

A company wants to give third-party developers access to the corporate network through desktop environments that the company can control. Which of the following can BEST achieve these requirements?

- A. Sandbox
- B. VDI
- C. Private cloud
- D. SaaS

Answer: B

Explanation:

VDI is a technology that allows a company to provide desktop environments to third-party developers while still maintaining control over the corporate network. VDI creates virtual desktops on a remote server, and each user gets their own desktop environment that is isolated from the other users. This allows the company to maintain control over the corporate network, as the virtual desktops are not directly connected to the corporate network.

NEW QUESTION 34

Which of the following commonly uses NFC?

- A. Contactless payments
- B. IoT devices
- C. Inventory tracking
- D. Tethering

Answer: C

NEW QUESTION 39

An engineer is experiencing unexpected reboots on a graphics workstation when rendering complex 3-D models. The workstation is configured with a 115V power supply that is rated at 200W and connected to a UPS. The central processing unit contains 16 hyperthreaded cores, and a discrete graphics solution utilizing an 8-pin power connector is installed in a PCI Express x16 slot. Which of the following indicates where the technician should begin troubleshooting?

- A. The UPS, as 115V is insufficient for the configuration and should be increased to 220V
- B. The power supply, as 200W is insufficient when the GPU is heavily tasked
- C. The graphics card, as it is the component that triggers the unexpected reboots
- D. The motherboard, as only standard PCI slots should be used for high-end graphics cards, not PCI Express slots

Answer: B

NEW QUESTION 42

A technician goes to a classroom to troubleshoot a projector that occasionally powers off. The technician recreates the issue and notices the projector will not power back on until approximately 15 minutes have passed. After 15 minutes of being powered on, the projector shuts off again. Which of the following should the technician perform NEXT to resolve the issue?

- A. Clean the filter.
- B. Adjust the standby timeout.
- C. Check the power cable connection.
- D. Replace the bulb.

Answer: A

NEW QUESTION 43

Which of the following is a method that can be used to securely connect a remote user's laptop to a corporate server?

- A. WAN
- B. VPN
- C. SSL
- D. DHCP

Answer: B

NEW QUESTION 48

Which of the following cables replaced the Apple 30-pin connector and is also reversible?

- A. USB-C
- B. Lightning
- C. miniUSB
- D. DisplayPort

Answer: B

Explanation:

Lightning Connector: Apple introduced this brand-new connector back in 2012. It is over 80% smaller than the 30-pin connector and is reversible.
https://www.cablewholesale.com/support/technical_articles/whats_your_port.php#:~:text=Lightning%20Connec

NEW QUESTION 52

A new version of Windows was released and a piece of software vital to the engineering department will not run on the new version. Which of the following is the BEST option to enable this department to be able to continue using this software?

- A. Do not upgrade any workstations within the organization.
- B. Upgrade all workstations and provide a virtual environment for the legacy software.
- C. Upgrade all workstations except those used by the engineering department.
- D. Purchase new workstations for the engineering department.

Answer: B

NEW QUESTION 53

A technician is setting up a new desktop computer and will be installing the hard drive directly on the motherboard without using cables to connect it. Which of the following will the technician be installing?

- A. Thunderbolt
- B. eSATA
- C. M.2
- D. SCSI

Answer: C

NEW QUESTION 55

A technician was called in to look at a user's PC. The user reported the PC was very sluggish. The HDD light on the PC was constantly on without blinking. The PC itself was slow receiving input and took a very long time to load the OS. The technician also noticed updates had failed. Which of the following is MOST likely the cause of these issues?

- A. The hard disk drivers have been corrupted
- B. The HDD cables need reseating.
- C. A RAID disk failed.
- D. The HDD has no free space.

Answer: A

NEW QUESTION 56

A technician needs to install a cost-effective storage device into a rackmount server that will be used as a VM host. This storage will be used for all VMs that run from the server. Which of the following should be used?

- A. Optical disk drive
- B. eMMC storage device
- C. 15,000rpm drive
- D. RAID 10 array

Answer: C

NEW QUESTION 59

A technician logs on to a PC and inserts an encrypted USB drive. When opening File Explorer, the technician cannot see the USB drive. Which of the following tools should the technician use to see all drives?

- A. DiskPart
- B. Diskmgmt
- C. Disk Cleanup
- D. BitLocker

Answer: D

NEW QUESTION 62

Which of the following wireless technologies has the MOST range and wireless throughput?

- A. 802.11ac
- B. 802.11ax
- C. 802.11b/g/n
- D. 802.11g

Answer: B

NEW QUESTION 67

A technician is troubleshooting a computer that is not completing POST and gets stuck at the manufacturer logo screen. All internal, removable parts have been disconnected and only the minimum parts necessary to POST were reconnected. However, the symptoms remain the same. Which of the following should the technician try NEXT?

- A. Test the RAM in different slots, one at a time.
- B. Remove and test the power supply.
- C. Replace the motherboard.
- D. Change the CMOS battery.

Answer: A

Explanation:

CMOS is for date and time and should not stop a host from booting. If working on a host with ECC memory you would test the ram in a different slot or a different Stick all together. If that did not work, I would swap in the other CPU to check if that is the issue. The ECC part isn't important other than that's what I'm used to working on at AWS and that is the only way you would be able to swap the CPUs easily.

NEW QUESTION 69

A technician needs to install a printer on the network. Which of the following must the technician configure? (Select THREE).

- A. PCL

- B. Dots per inch
- C. Gateway
- D. Subnet mask
- E. MAC address
- F. MB
- G. IP address
- H. Drivers

Answer: AEH

NEW QUESTION 73

A user is unable to access the internet on a PC. A technician examines the PC and runs the following commands:

```
ipconfig /all  
ping 8.8.8.8  
ping comptia.org
```

Which of the following steps in the troubleshooting process does this series of commands represent?

- A. Establish a theory.
- B. Verify full system functionality.
- C. Establish a plan of action.
- D. Identify the problem.

Answer: B

NEW QUESTION 77

An office manager reports that a printer is experiencing performance issues. Printouts are smudging when they are handled, and, recently, whenever the manager tries to print oversized documents, the paper jams before anything is printed on it.



- A. Mastered
- B. Not Mastered

Answer: A

Explanation:

A picture containing text, electronics, printer Description automatically generated

NEW QUESTION 81

A technician is diagnosing a workstation that shuts down unexpectedly during a butn-in test. Which of the following is the MOST likely cause for this symptom?

- A. Faulty CMOS battery
- B. OS update issue
- C. Overheating
- D. Faulty RAM

Answer: C

NEW QUESTION 85

A technician is configuring a new CAD workstation that has four large hard drives. The workstation will be used to edit large, critical files, so the storage configuration should be both fast and redundant. Which of the following RAID levels BEST meets these requirements?

- A. 1
- B. 5
- C. 10

Answer: D

Explanation:

<https://techgenix.com/raid-10-vs-raid-5/>

NEW QUESTION 87

A technician is preparing to set up a gaming computer with the following components:

- Discrete, high-end graphics card
- Video capture card
- High-end processor
- Multiple hard drives
- USB 3.0 hub
- Sound card

Which of the following options is the MOST important for the technician to consider before building the gaming computer?

- A. Redundant power supply
- B. Modular power supply
- C. 20-pin v
- D. 24-pin power adapter
- E. Power supply wattage rating

Answer: D

NEW QUESTION 90

An end user reports that the time and date on a desktop resets after shutdown, and subsequently, the device reboots. The next day, the desktop does not load the OS and is stuck at a black screen with the following message:

```
Date/Time Not Set
Press F1 to Run Setup
```

Which of the following would be the BEST action to take next?

- A. Change the motherboard.
- B. Reseat the motherboard power connections.
- C. Replace the CMOS battery.
- D. Restore the BIOS to factory default settings.

Answer: C

NEW QUESTION 91

A system administrator has been tasked with allowing SMTP traffic through the system's host-based firewall. Which of the following ports should the administrator enabled?

- A. 23
- B. 25
- C. 80
- D. 161

Answer: A

NEW QUESTION 93

A technician is inspecting a projector that is displaying fuzzy images. Which of the following actions would provide the BEST solution?

- A. Adjusting the lens
- B. Changing the filter
- C. Replacing the video cable
- D. Reseating the lamp

Answer: A

NEW QUESTION 98

A company just bought a printer capable of automatically printing on both sides of the paper After installation, however, the technician can only print on both sides of the paper manually. Which of the following should the technician do to fix the issue?

- A. Install the most recent firmware upgrade available for the printer.
- B. Contact the vendor for a hardware replacement.
- C. Reinstall the printer software and drivers, and then restart the printer.
- D. Read the installation manual and configure duplex settings.

Answer: D

NEW QUESTION 99

A startup company is outgrowing its current office space and is requiring employees to work remotely. The company must comply with government-enforced requirements to safeguard all aspects of data, so the IT department plans to maintain complete control over users' operating systems. Which of the following should the IT department implement?

- A. VDI
- B. IaaS
- C. VPN
- D. SaaS

Answer: A

NEW QUESTION 101

A technician is investigating the output shown on a monitor. The output is clear, but it has a pink hue. The technician has replaced the video card and updated the graphics drivers. Which of the following would be the MOST likely cause?

- A. Physical cabling issues
- B. Burned-out bulb
- C. Display burn-in
- D. Incorrect data source

Answer: A

NEW QUESTION 103

A technician installed new firmware on the company's laser printers and has since been receiving multiple calls that information is garbled and looks like code. Only printers with the new firmware are having this issue. Which of the following steps should the technician complete NEXT?

- A. Change the language settings on the printers
- B. Reboot all the machines having the issues
- C. Reboot all the printers.
- D. Install an updated printer driver on the print server

Answer: C

NEW QUESTION 106

A new employee has been issued a company laptop. The employee requests an accessory with a single power source that has wired network connectivity and supports a keyboard, mouse, speakers, and dual monitors. Which of the following accessories should the systems administrator deploy to BEST meet the new user's needs?

- A. PoE switch
- B. USB-C hub with power delivery
- C. Docking station with DisplayPort
- D. KVM switch with audio

Answer: C

NEW QUESTION 109

A hardware technician is configuring a laptop, and the network administrator requires the network settings to be static. The technician successfully pings the servers by IP address but cannot ping the UNC path. Which of the following is the cause of this issue?

- A. Domain Name System
- B. Gateway
- C. Subnet
- D. IP address

Answer: A

NEW QUESTION 112

A user requested upgrades to a company-issued laptop to increase its performance while working with a large database stored on drive C. Which of the following tasks should a systems administrator complete to BEST meet this goal? (Select TWO).

- A. Configure RAID 1.
- B. Install a hybrid drive.
- C. Upgrade to 1GB NIC.
- D. Increase the RAM.
- E. Migrate to a SSD.
- F. Upgrade the power supply.

Answer: BD

Explanation:

CompTIA covers it in page 97 of the comptia A+ complete study guide.

NEW QUESTION 114

A technician has set up a new conference room with a TV and a video soundbar. The technician wants to test the system with a conference call. During the test, the TV speaker produces sound, but the soundbar does not.

Which of the following is the MOST likely cause of the issue?

- A. The volume on the TV needs to be turned up.
- B. The conference call needs to be unmuted for audio.
- C. An incorrect HDMI cable is being used.
- D. The TV's HDMI-ARC port is not being use

Answer: D

Explanation:

HDMI-ARC (Audio Return Channel) is an HDMI connection that allows audio to be sent from the TV to an external sound system, such as a soundbar. If the TV's HDMI-ARC port is not being used, then the soundbar will not receive any audio from the TV and thus will not produce any sound. To resolve the issue, the technician should ensure that the TV's HDMI-ARC port is being used to connect the TV to the soundbar.

NEW QUESTION 115

A user creates a support ticket to report a conference room projector that does not work. The user says that even though the provided cables are being used, the projector screen shows the following error message:

No signal input

Which of the following describes the FIRST action that should be taken?

- A. Verify that the projector is turned on.
- B. Verify that the user is using an approved OS.
- C. Replace the projector bulb.
- D. Check the video cable and replace it if necessary.

Answer: D

Explanation:

The most common reasons you may be seeing the "No Signal" message: The projector and the source device are not connected correctly.

NEW QUESTION 120

A technician receives several error alerts on a server after an unexpected reboot. A message states that one or more disks are in a degraded state. When the technician advances to the next error message, it indicates the OS is missing. Which of the following are the MOST likely causes of these errors? (Choose two.)

- A. Missing drives in the OS
- B. RAID failure
- C. Bootable device not found
- D. Data loss
- E. Controller failure
- F. CMOS corruption
- G. TPM malfunction

Answer: BC

NEW QUESTION 122

A technician is installing new power supplies for the application engineering team's workstations. The management team has not yet made a decision about installing dual graphics cards, but they want to proceed with the project anyway. Which of the following power supplies would provide the BEST solution?

- A. 1000W 24-pin modular power supply
- B. 220VAC 9000J surge protector
- C. 500W redundant power supply
- D. 2000VA uninterruptible power supply

Answer: A

NEW QUESTION 125

A user connects a smartphone to a laptop. Which of the following types of networks has the user created?

- A. PAN
- B. MAN
- C. WLAN
- D. LAN

Answer: A

NEW QUESTION 127

Which of the following 802.11 standards supports both 5GHz and 2.4GHz channel frequencies?

- A. 802.11a
- B. 802.11c
- C. 802.11b
- D. 802.11g

Answer: B

NEW QUESTION 131

A small ISP has hired a new technician Joe, the new technician, is being trained to configure customers* home networks The trailing instructor gives me technician a starter kit with cables, cable ends, and other network equipment and asks mm to build a working network.

The computer should be connected to have internet connectivity and the phone should be connected to have a dial tone.

INSTRUCTIONS

Use the appropriate cables. cable ends, tools and equipment to configure the network ana connect an components accordingly

There are 3 steps and the simulation starts on step 1.

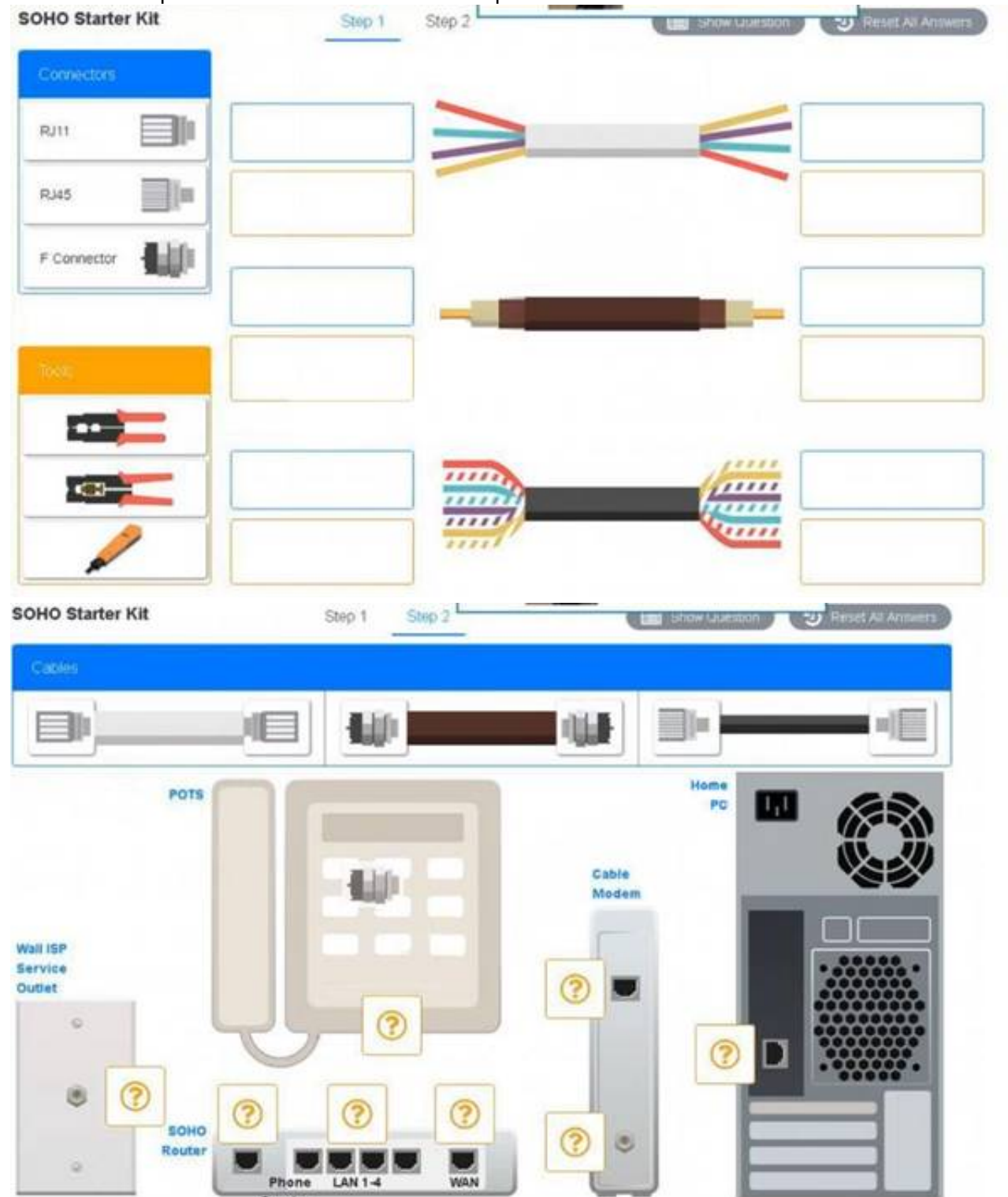

- A. Mastered
- B. Not Mastered

Answer: A

Explanation:

Answer of both steps below.

A picture containing text, screenshot, indoor Description automatically generated

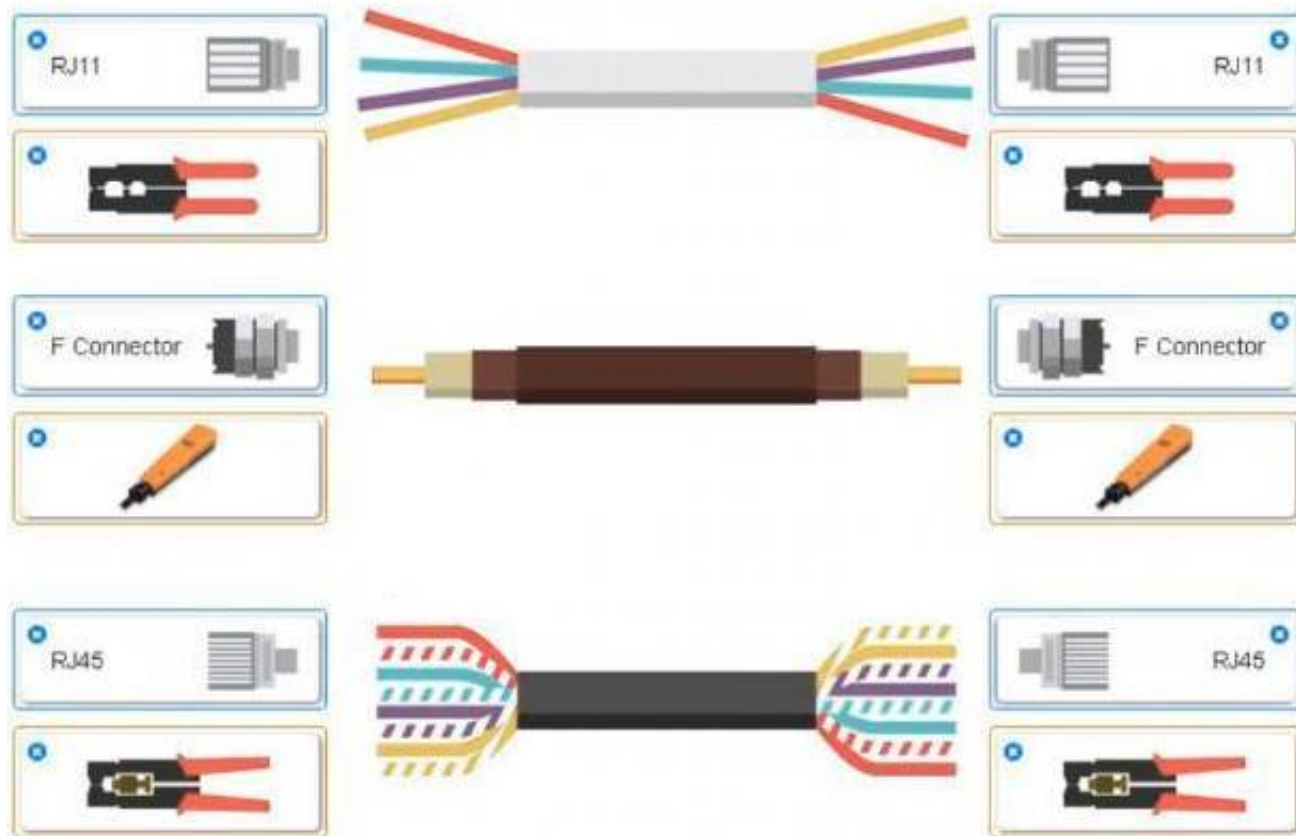
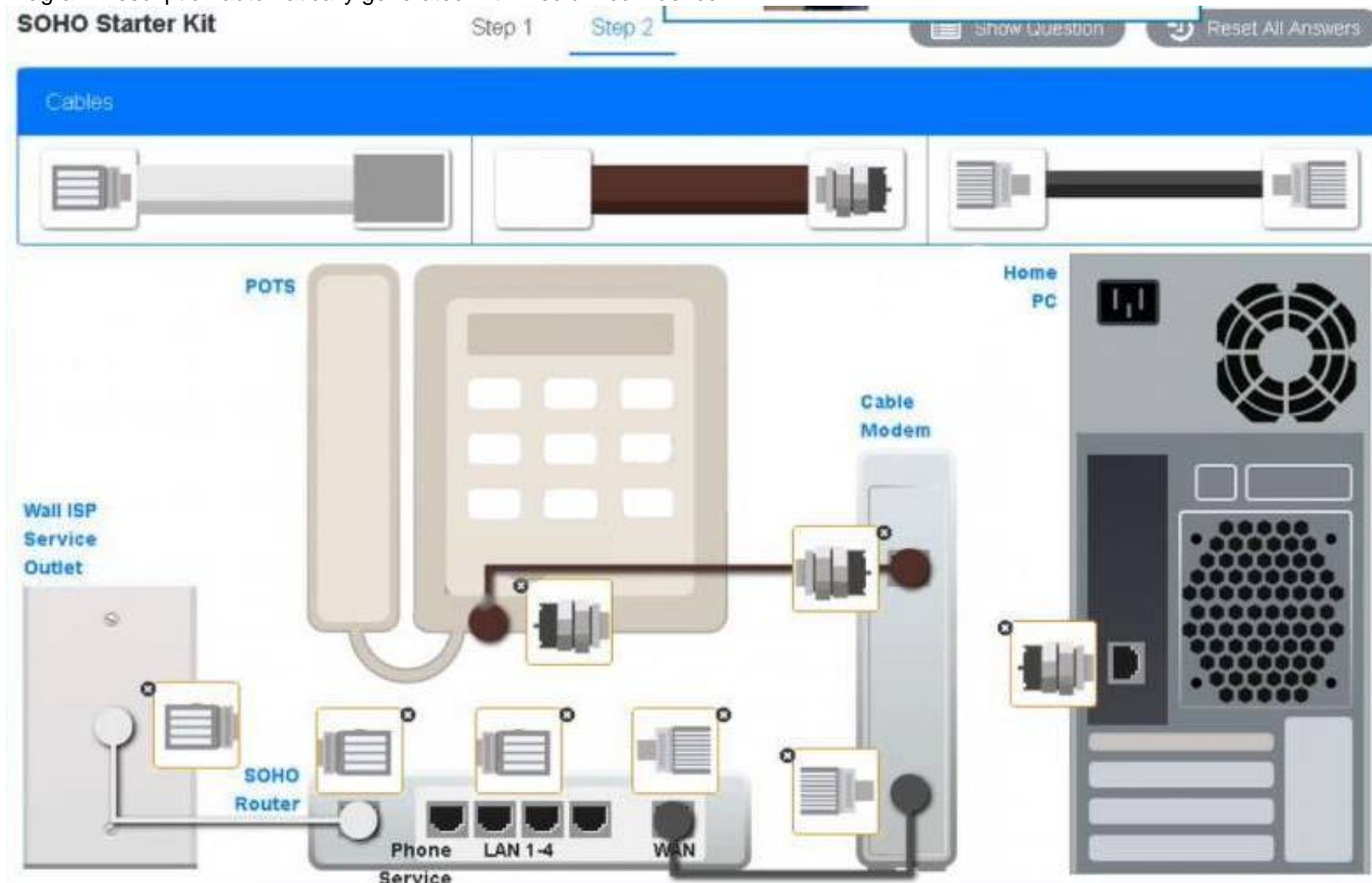

Diagram Description automatically generated with medium confidence



NEW QUESTION 135

A technician is upgrading a faulty motherboard that was ordered by an end user for an old, high-end desktop computer. However, the technician is unable to install the CPU into the socket. Upon closer inspection, the technician notices the pins on the CPU do not line up with the socket. Which of the following would be the best course of action for the technician to take NEXT?

- A. Try to set as many pins as possible.
- B. Install an adaptor to create a universal socket.
- C. Verify the socket type and manufacturer.
- D. Find a compatible motherboard for the CPU.

Answer: C

Explanation:

you need to know the socket type before you can go and find the replacement motherboard

NEW QUESTION 138

The IT department at an insurance brokerage needs to acquire laptops that have built-in fingerprint readers in order to create a more secure environment. Which of the following would be the MOST secure way to implement the fingerprint readers?

- A. Grant all registered employees access to each machine.
- B. Restrict device access to only the user to whom the laptop is assigned.

- C. Limit device access to departments and guest users.
- D. Give each team member a USB drive that bypasses the reader to allow guest users to log in.

Answer: B

NEW QUESTION 141

Which of the following network devices would an administrator use to distribute traffic evenly throughout multiple nodes?

- A. Load balancer
- B. Bridge
- C. Proxy server
- D. Switch
- E. Firewall

Answer: A

Explanation:

A load balancer is a network device that distributes network or application traffic across multiple servers to ensure that no single server bears too much of the load. Load balancing helps to improve application availability, increase scalability, and optimize resource utilization.

A bridge is used to connect two different networks, often to divide a larger network into smaller segments. A proxy server is used to forward client requests to other servers, and can also be used to cache frequently requested data. A switch is used to connect multiple devices within a network and to control the flow of network traffic. A firewall is used to secure a network by controlling incoming and outgoing traffic based on defined security rules.

NEW QUESTION 146

A user in a medical office contacts a technician regarding a printer that is used to print A4-sized labels. After the labels are printed, they mistakenly contain white space in the middle of the page. Which of the following would MOST likely be the cause?

- A. Contaminated fuser
- B. Worn rollers
- C. A misfeed
- D. Page orientation

Answer: A

Explanation:

The most common symptoms that indicate fuser deterioration are: The print leaves parallel spots across a sheet. The printer begins to loosen toner and does not stick to the sheet. Stains on printed sheets. Annoying noise from gear wear. The fusers are the core in the printing process of a laser printer. The Fuser is the piece that fixes the toner on the paper.

NEW QUESTION 149

A user reports that printed receipts have black smudges over the entire image. The text is still present but is very dark and sometimes illegible. Which of the following are the MOST likely cause and solution for the printer issue?

- A. The ribbon is jammed and is rubbing on the paper
- B. Clear the bad ribbon and feed it through properly.
- C. The printhead is too hot
- D. Adjust the temperature down and retry printing.
- E. The printer is loaded with the wrong type of paper
- F. Replace the receipt paper with carbon paper.
- G. The blue ink cartridge was loaded with black ink
- H. Put in the correct ink and clean the printhead.

Answer: B

Explanation:

Receipts are printed via a thermal printer. Thermal printers work by heating a paper in specified areas in order to create an image. The specific component that does this is a thermal printhead. Since the image appears to have black smudges and is too dark, we know the thermal printhead is too hot since the capability of precise heating has diminished.

NEW QUESTION 153

A company needs to support a 10Gbps throughput. Which of the following is the MINIMUM cable category that could be used?

- A. Cat 5
- B. Cat 5e
- C. Cat 6
- D. Cat 6a

Answer: C

NEW QUESTION 155

A user sends a print job to a network printer, and the print job uses double the amount of paper as expected. Which of the following should the user configure to get the expected result?

- A. Duplex
- B. Collate
- C. Landscape
- D. Transparency

Answer: A

NEW QUESTION 159

A technician set up a new access point and has noticed significant latency on the selected channel. Which of the following tools can assist with locating the BEST channel to use?

- A. Wi-Fi analyzer
- B. Netstat
- C. Net use
- D. Traceroute
- E. Network tap

Answer: A

Explanation:

A Wi-Fi analyzer is a tool that can be used to scan the local area for available wireless networks and can provide information such as signal strength, interference, and available channels. It can also be used to locate the best channel to use for a given access point, which can help to reduce latency and improve performance.

NEW QUESTION 161

A home user has purchased a subscription for a service that blocks malicious sites by preventing them from resolving correctly. Which of the following settings MOST likely needs to be changed on the user's router to enable this functionality?

- A. DNS server
- B. Port forwarding
- C. Perimeter network
- D. Universal PnP
- E. DHCP server

Answer: A

NEW QUESTION 162

A technician is replacing the RAM on an entry-level server with hot-swappable components. Which of the following should the technician do NEXT?

- A. Replace the RAM while the server is at a cool temperature
- B. Replace the RAM while the server is running
- C. Power down the server completely and then replace the RAM
- D. Verify that the OS supports hot swapping the RAM

Answer: C

NEW QUESTION 167

A user calls the help desk for assistance configuring an Android phone with a new NFC-enabled speaker that will be used for an upcoming conference call. The user was unable to direct the phone's audio to the NFC speaker. Which of the following sequences should the help desk technician walk the customer through to accomplish this task?

- A. Enable NFC on the speaker
- B. Ensure the speaker is less than 33ft (10m) from the Android phone
- C. On the phone's Bluetooth settings menu for Connected Devices, select Pair New Device
- D. Tap to accept the connection to the speaker when the prompt is displayed on the phone's screen.
- E. Enable NFC and Bluetooth on the Android phone
- F. From the Android phone's Bluetooth settings menu for Connected Devices, select the Previously Connected Devices option
- G. Select a listed device that most closely matches the speaker
- H. Tap to accept the connection to the speaker when the prompt is displayed on the phone's screen.
- I. Enable NFC and Bluetooth on the Android phone
- J. Tap and hold the Android phone to the spot on the speaker where the NFC logo is displayed
- K. Accept the connection to the speaker when the prompt is displayed on the phone's screen.
- L. Enable Wi-Fi on the speaker
- M. Enable Wi-Fi on the Android phone
- N. Tap and hold the Android phone to the spot on the speaker where the NFC logo is displayed
- O. Accept the connection to the speaker when the prompt is displayed on the phone's screen.

Answer: A

NEW QUESTION 172

Which of the following is used to implement network security policies for an environment?

- A. Managed switch
- B. Repeater
- C. Firewall
- D. Gateway

Answer: A

NEW QUESTION 176

A network administrator was notified that laptop users are unable to access or ping any network resources on the corporate network. Which of the following should the network administrator check FIRST?

- A. DHCP
- B. AAA
- C. DHB
- D. ARP

Answer: A

Explanation:

Domain Name System (DNS) is an Internet service that translates domain names (e.g., its.umich.edu) into IP addresses. Dynamic Host Configuration Protocol (DHCP) is a protocol for automatically assigning IP addresses and other configurations to devices when they connect to a network.

NEW QUESTION 179

Which of the following cloud models maintains access, even when a local internet outage occurs?

- A. Private
- B. SaaS
- C. Community
- D. Public

Answer: A

Explanation:

In a private cloud model, the cloud infrastructure is maintained within a company's own data center and is used exclusively by that company. Private clouds offer the advantage of maintaining access even when a local internet outage occurs, since the cloud infrastructure is not dependent on a public network connection. Software as a Service (SaaS) is a cloud model in which software applications are hosted by a third-party provider and made available to customers over the internet. SaaS is not designed to maintain access in the event of a local internet outage.

A community cloud is a shared infrastructure that is used by multiple organizations, typically from the same industry or with similar requirements. Community clouds are not designed to maintain access in the event of a local internet outage.

A public cloud is a cloud infrastructure that is maintained by a third-party provider and is made available to the public over the internet. Public clouds are not designed to maintain access in the event of a local internet outage.

NEW QUESTION 183

A field technician has been dispatched to a site with an internet outage. Upon arriving, the technician discovers that the POTS lines are not working as well. Which of the following technologies is the site MOST likely using?

- A. Fiber
- B. Cable
- C. DSL
- D. Satellite

Answer: C

NEW QUESTION 187

A user is trying to play a DVD on a projector. The user can hear the audio; however, the projector is showing an error message that states:

HDMI Blocked due to Copy Protection

Which of the following is the MOST likely cause of the error?

- A. The HDMI cannot carry the signal from the DVD to the projector.
- B. The user needs to switch from HDMI to a cable standard such as DisplayPort.
- C. The projector does not support the necessary HDCP protocol.
- D. The user needs to enable cony-protected sources in the projector's settings.

Answer: C

Explanation:

The Official CompTIA® A+® Core 1 and Core 2 Student Guide (Exams 220-1001 and 220-1002) | 193 Protected content. If you encounter an error that indicates unauthorized content or an HDCP error: • DVI, HDMI, DisplayPort, and Thunderbolt all provide support for the Digital Rights Management (DRM) mechanism High-bandwidth Digital Content Protection (HDCP). HDCP allows a content source (such as a Blu-ray disc) to disable itself if the display adapter and monitor and/or speaker system do not support HDCP and fail to authenticate themselves with the playback source. There have been various iterations of HDCP (at time of writing the current version is 2.2) and backward-compatibility can be problematic as authentication may fail between devices that support different versions of the standard.

NEW QUESTION 191

A technician is replacing a ribbon on a printer that produces faded text and Images when priming. Which of the following types of primers is the technician working on?

- A. Impact
- B. Inkjet
- C. Laser
- D. Thermal

Answer: D

NEW QUESTION 194

While using a popular videoconferencing program, the user selects a webcam, but the software is unable to open the webcam. The webcam was working the previous day. Which of the following should be done to address this issue?

- A. Close other video software and retry.

- B. Adjust the conference software to a compatible resolution.
- C. Switch the video from the webcam to "conference" mode.
- D. Reseat or replace the webcam.

Answer: A

Explanation:

Web cameras can input to one software at a time. Closing other video software is the first step in troubleshooting the issue as it doesn't require customer or on-site support. After restarting the computer and adjusting the drivers, it would be time to ask the customer to reseat the webcam or replace the device.

NEW QUESTION 195

Which of the following is the MAXIMUM power PoE+ provides?

- A. 15.4W
- B. 30W
- C. 60W
- D. 95W

Answer: B

Explanation:

The earliest PoE switches from a few years ago generated 15 Watts per port (IEEE 802.3af). Today, most use the PoE+ standard (IEEE 802.3at), which generates up to 30 Watts per port. That's plenty for most devices that people want to connect

NEW QUESTION 199

A small office has a wireless network with several access points for roaming laptop use. Users occasionally report that the wireless connection drops or becomes very slow. Users have confirmed that this issue only happens when connected to the office wireless network. Which of the following would MOST likely be the cause?

- A. Hidden SSID
- B. Device interference
- C. Ethernet port flapping
- D. High ISP latency

Answer: B

NEW QUESTION 200

Which of the following are default ports for HTTP and HTTPS traffic? (Select TWO).

- A. 23
- B. 25
- C. 80
- D. 143
- E. 389
- F. 443

Answer: CF

NEW QUESTION 204

.....

Thank You for Trying Our Product

* 100% Pass or Money Back

All our products come with a 90-day Money Back Guarantee.

* One year free update

You can enjoy free update one year. 24x7 online support.

* Trusted by Millions

We currently serve more than 30,000,000 customers.

* Shop Securely

All transactions are protected by VeriSign!

100% Pass Your 220-1101 Exam with Our Prep Materials Via below:

<https://www.certleader.com/220-1101-dumps.html>