

Exam Questions PL-500

Microsoft Power Automate RPA Developer

<https://www.2passeasy.com/dumps/PL-500/>



NEW QUESTION 1

- (Exam Topic 1)

You need to configure the solution.

What should you use? To answer, select the appropriate options in the answer area. NOTE: Each correct selection is worth one point.

Answer Area

Requirement	Option
Automate the SMSApp data entry process.	<div>Action</div> <div>Workflow</div> <div>Desktop flow</div> <div>Mobile task flow</div>
Handle invoices sent to the Accounts payable mailbox.	<div>When a folder is created</div> <div>When an item is created</div> <div>When a new email arrives</div> <div>When a new email arrives in a shared mailbox</div>
Implement the order process.	<div>Workflows</div> <div>Instant flows</div> <div>Business rules</div> <div>Business process flows</div>

- A. Mastered
- B. Not Mastered

Answer: A

Explanation:

Answer Area

Requirement	Option
Automate the SMSApp data entry process.	<div>Action</div> <div>Workflow</div> <div>Desktop flow</div> <div>Mobile task flow</div>
Handle invoices sent to the Accounts payable mailbox.	<div>When a folder is created</div> <div>When an item is created</div> <div>When a new email arrives</div> <div>When a new email arrives in a shared mailbox</div>
Implement the order process.	<div>Workflows</div> <div>Instant flows</div> <div>Business rules</div> <div>Business process flows</div>

NEW QUESTION 2

- (Exam Topic 2)

You need to configure sharing for MaintenanceScheduler.

Which sharing methods should you use? To answer, select the appropriate options in the answer area. NOTE: Each correct selection is worth one point.

Answer Area

User	Sharing method
User1	<div>Share as user</div> <div>Share as owner</div> <div>Share as co-owner</div> <div>Share as run-only user</div>
User2	<div>Share as user</div> <div>Share as owner</div> <div>Share as co-owner</div> <div>Share as run-only user</div>
User3	<div>Share as user</div> <div>Share as owner</div> <div>Share as co-owner</div> <div>Share as run-only user</div>

- A. Mastered
- B. Not Mastered

Answer: A

Explanation:

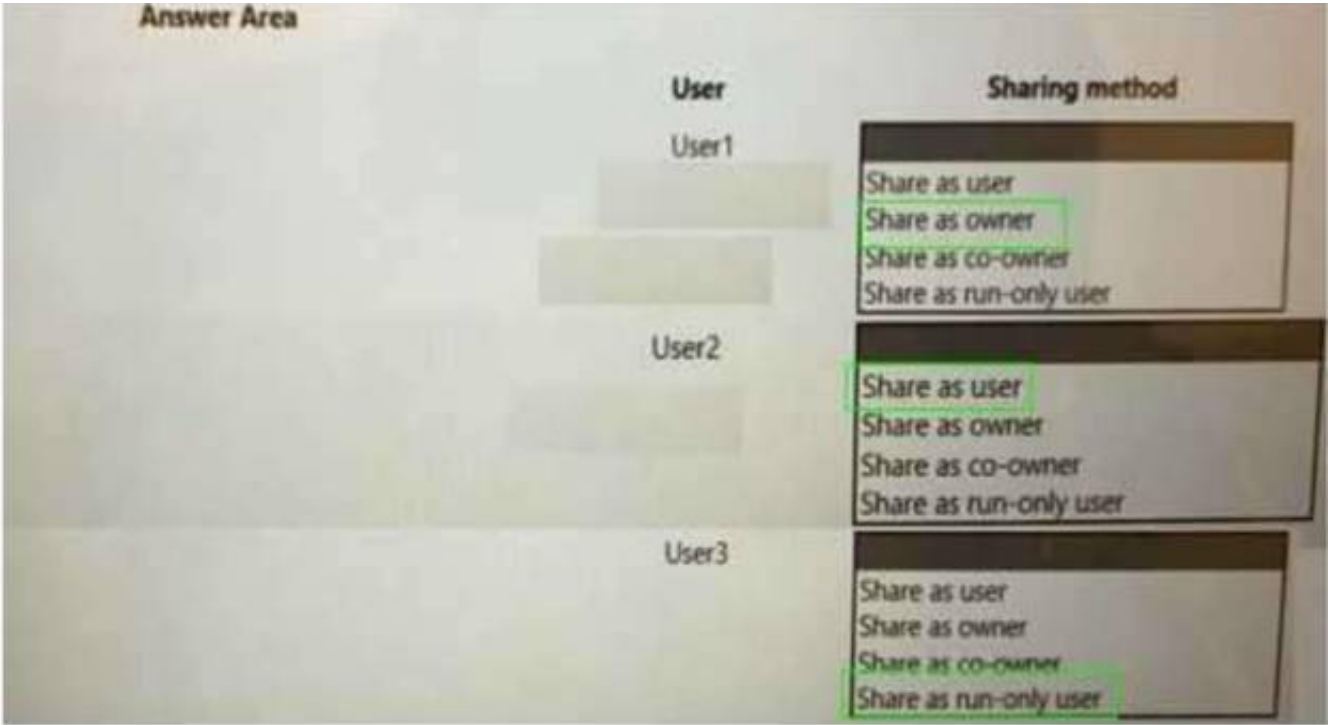

NEW QUESTION 3

- (Exam Topic 2)

You need to resolve the issue with the DataCollector flow.

What are two possible ways to achieve the goal? Each correct answer presents a complete solution. NOTE: Each correct selection is worth one point

- A. Add an If web page contains action to determine whether a field exists and write data only when true.
- B. Configure the Populate text field on a web page actions to continue running the flow in case of error.
- C. Replace the Populate text field on a web page action with the Send keys action to write data.
- D. Remove the Focus text field on a web page actions that precede actions which write data to text fields.
- E. Modify selectors to ensure that field attributes are mapped correctly.

Answer: BCE

NEW QUESTION 4

- (Exam Topic 3)

You plan to implement a data loss prevention (DLP) policy for a production environment. You need to define the policy.

Which four actions should you perform in sequence? To answer, move the appropriate actions from the list of actions to the answer area and arrange them in the correct order.

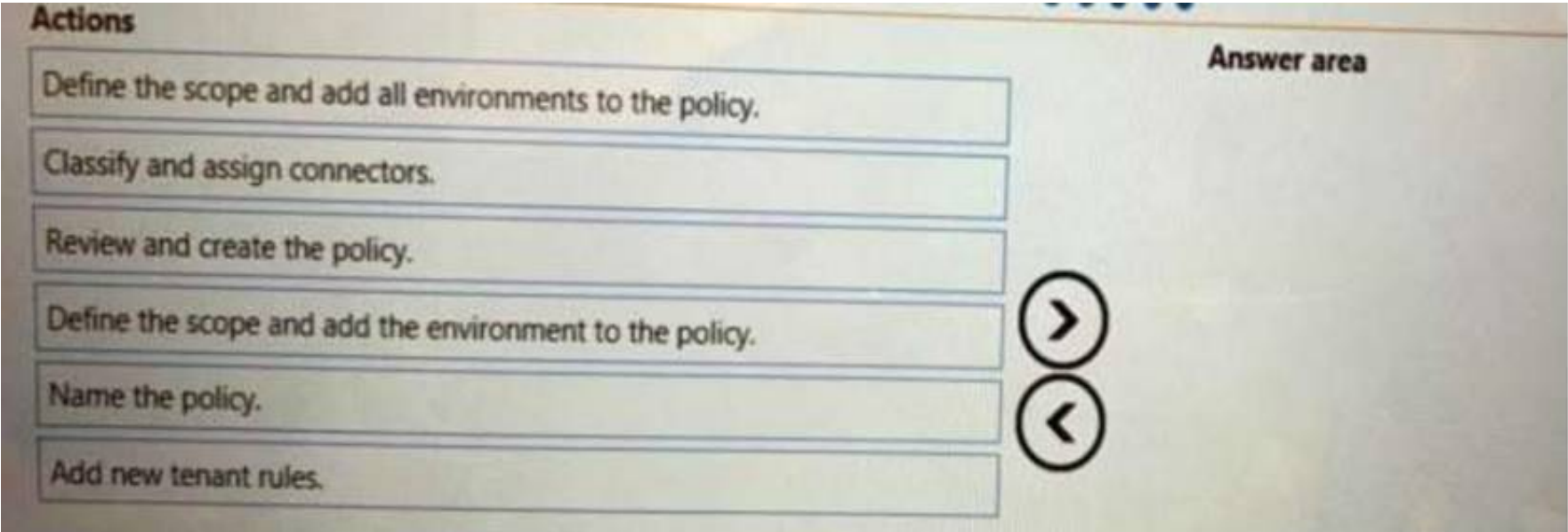

- A. Mastered
- B. Not Mastered

Answer: A

Explanation:

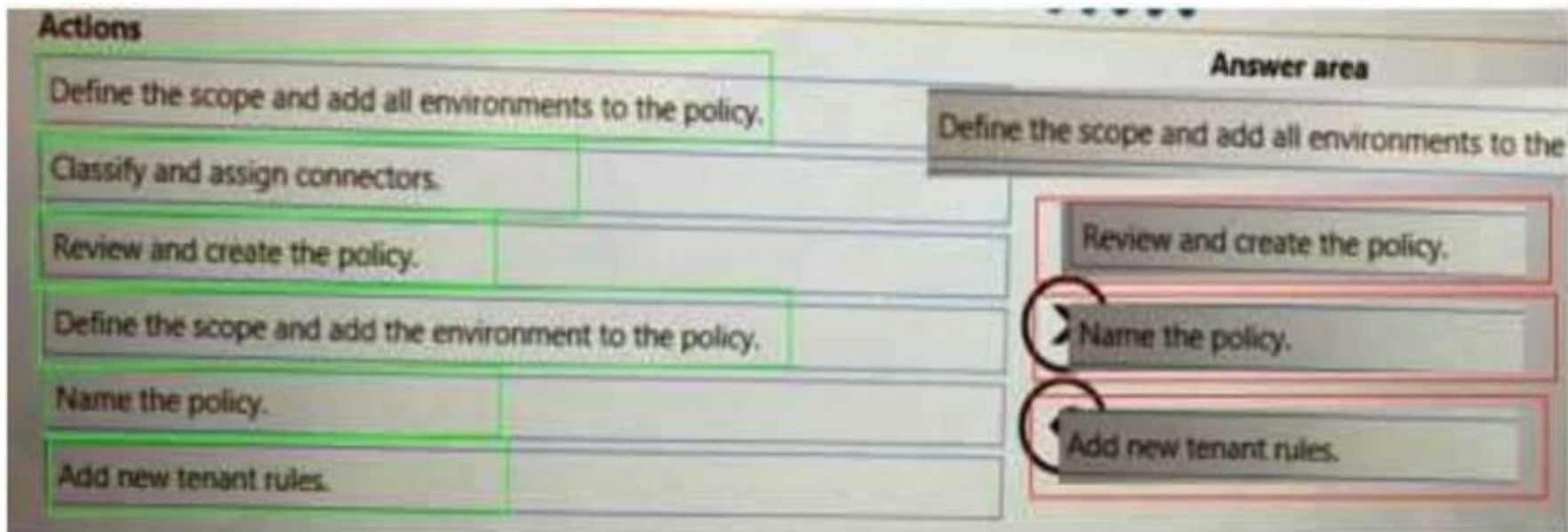

NEW QUESTION 5

- (Exam Topic 3)

You are developing automation solutions for a company. You need to use an environment variable in a cloud flow.
Which three actions should you perform in sequence? To answer, move the appropriate actions from the list of actions to the order.

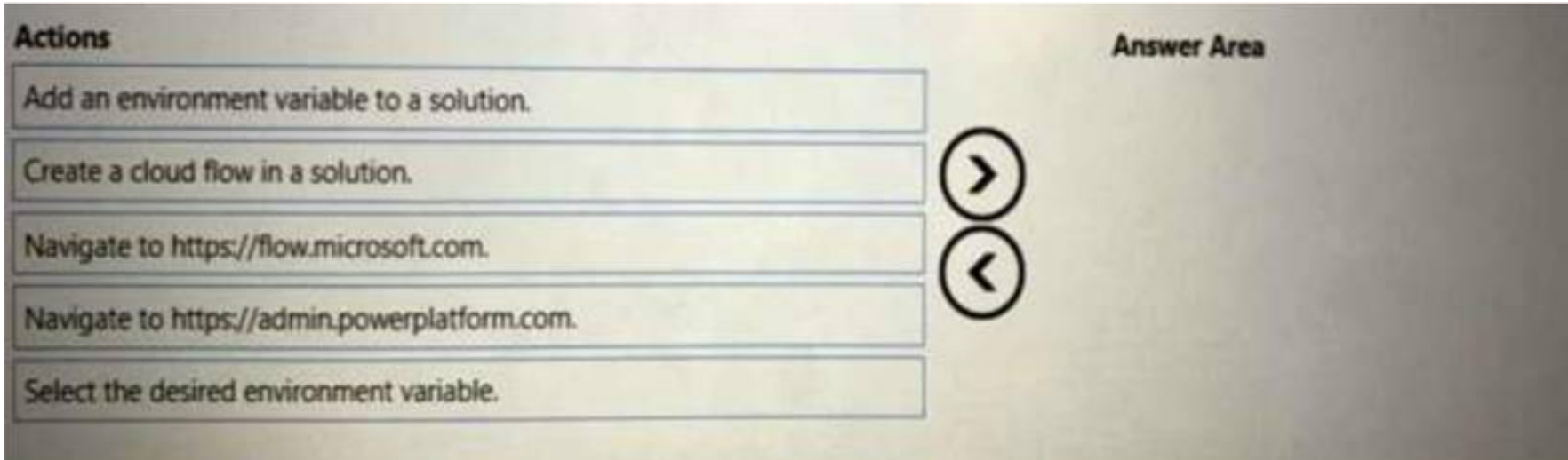

- A. Mastered
- B. Not Mastered

Answer: A

Explanation:

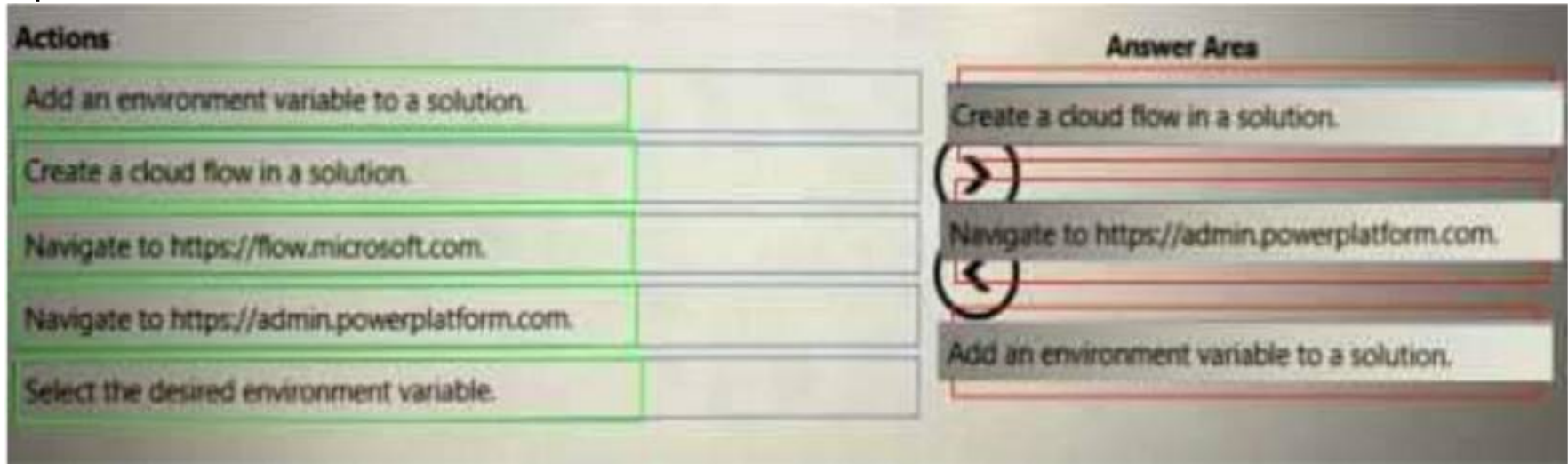

NEW QUESTION 6

- (Exam Topic 3)

You are developing automation solutions for a company.
You need to use an environment variable in a cloud flow.
Which three actions should you perform in sequence? To answer, move the appropriate actions from the list of actions to the answer area and arrange them in the correct order.

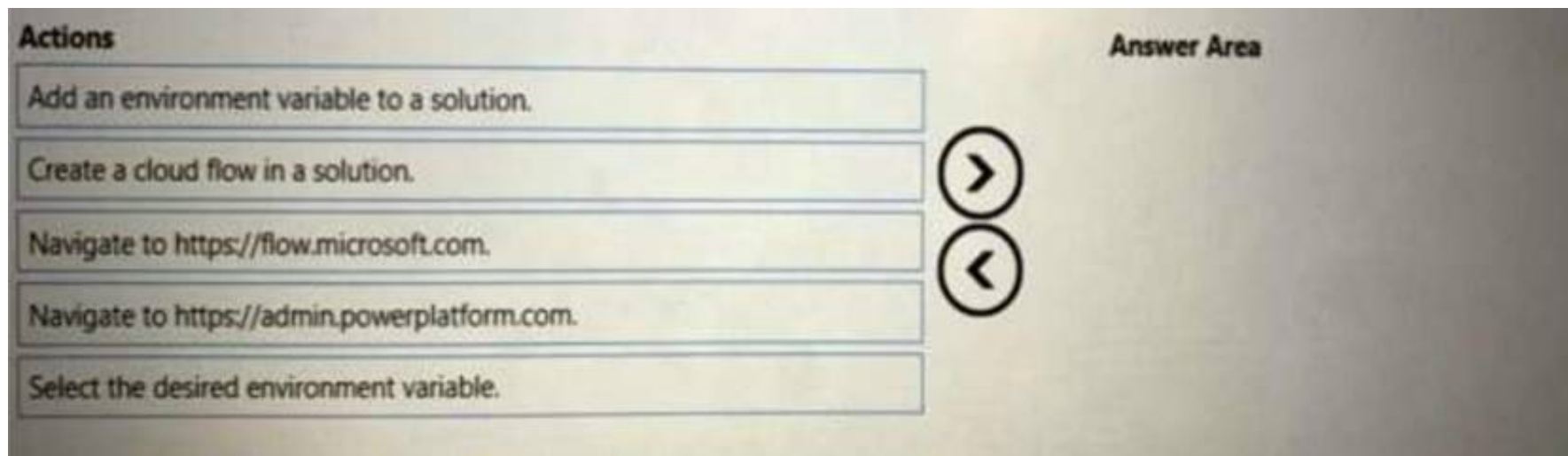

- A. Mastered
- B. Not Mastered

Answer: A

Explanation:

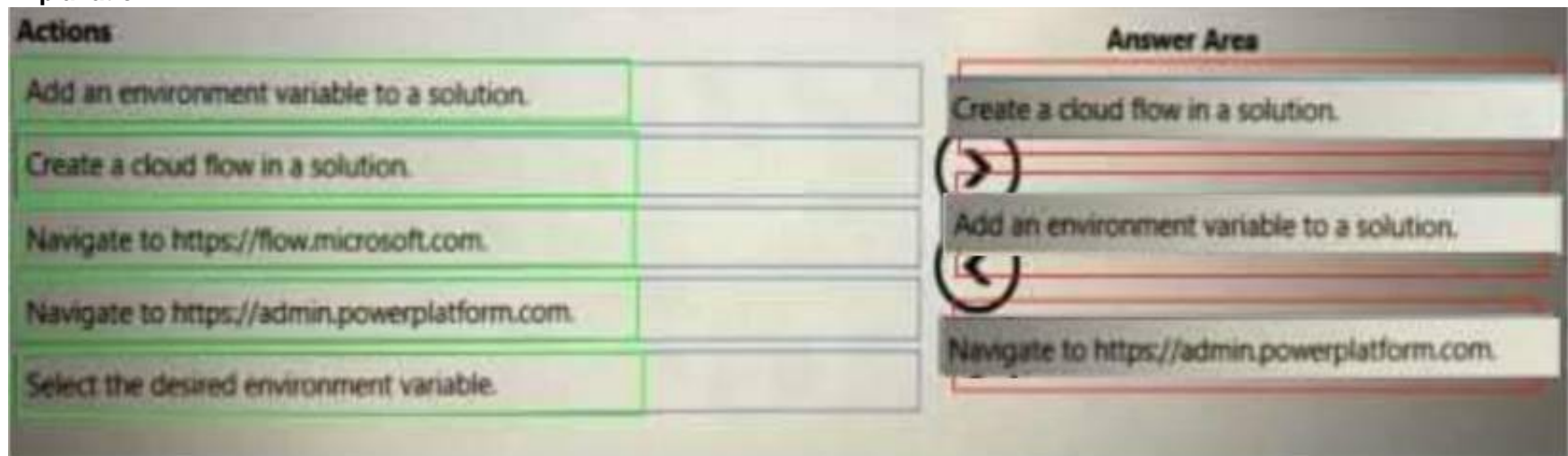

NEW QUESTION 7

- (Exam Topic 3)

A company publishes a list of contacts each day as an HTML table on a web page. The company has a customer relationship management (CRM) application that runs on employee desktop devices.

You need to implement an RPA solution that reads data from the HTML table and create records in the CRM application.

Which four actions should you perform in sequence? To answer, move the appropriate actions from the list of actions to the answer area and arrange them in the correct order.

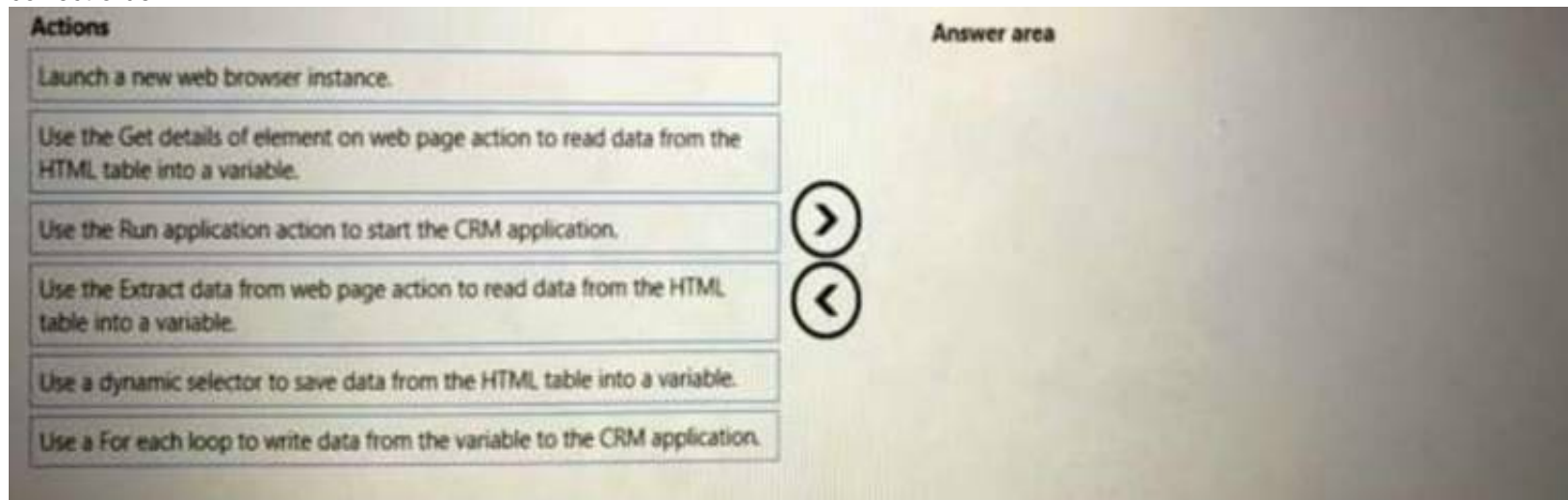

- A. Mastered
- B. Not Mastered

Answer: A

Explanation:

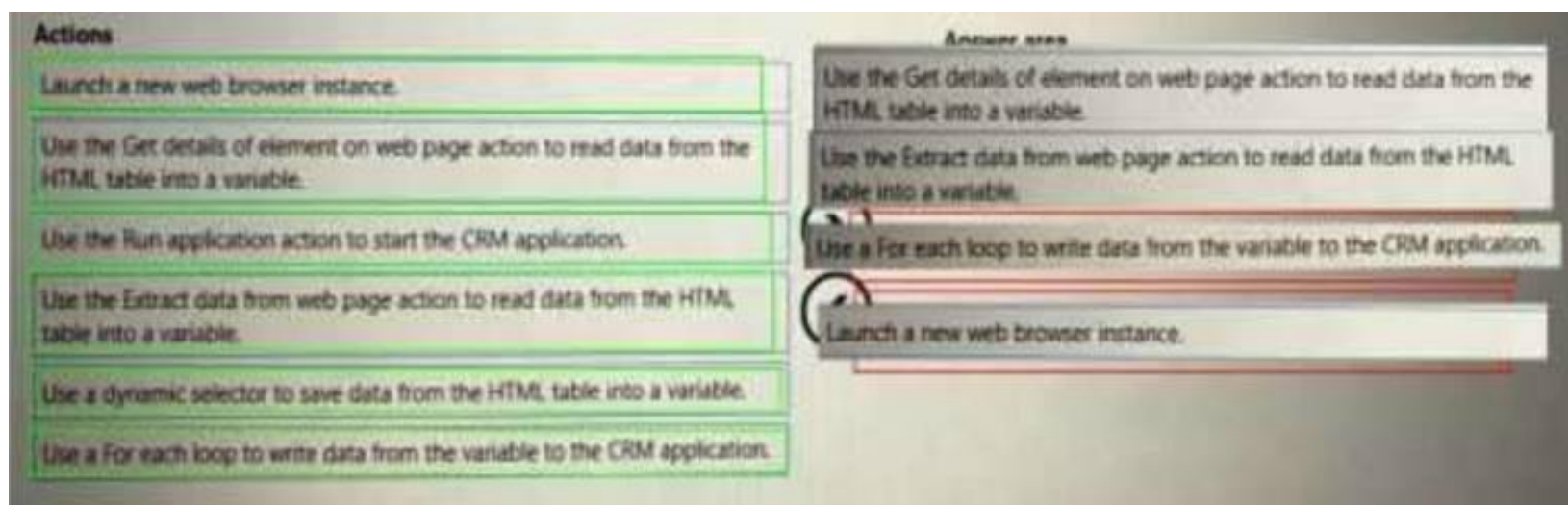

NEW QUESTION 8

- (Exam Topic 3)

You have a machine that runs an automation solution. You need to move the machine to a different environment.

Which three actions should you perform in sequence? To answer, move the appropriate actions from the list of actions to the answer area and arrange them in the coned order.

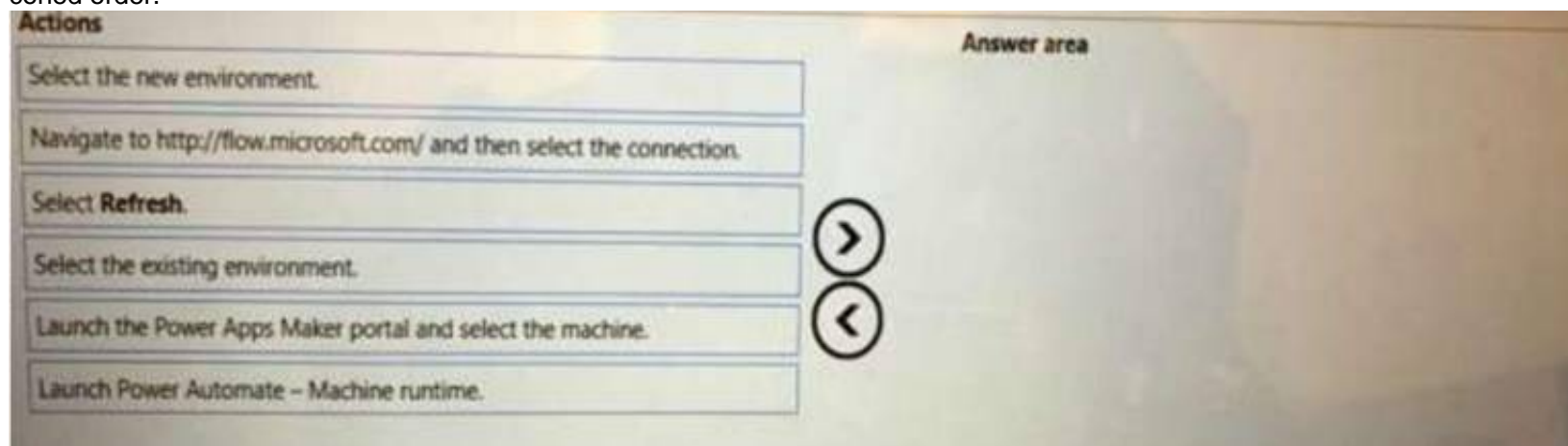

- A. Mastered
- B. Not Mastered

Answer: A

Explanation:

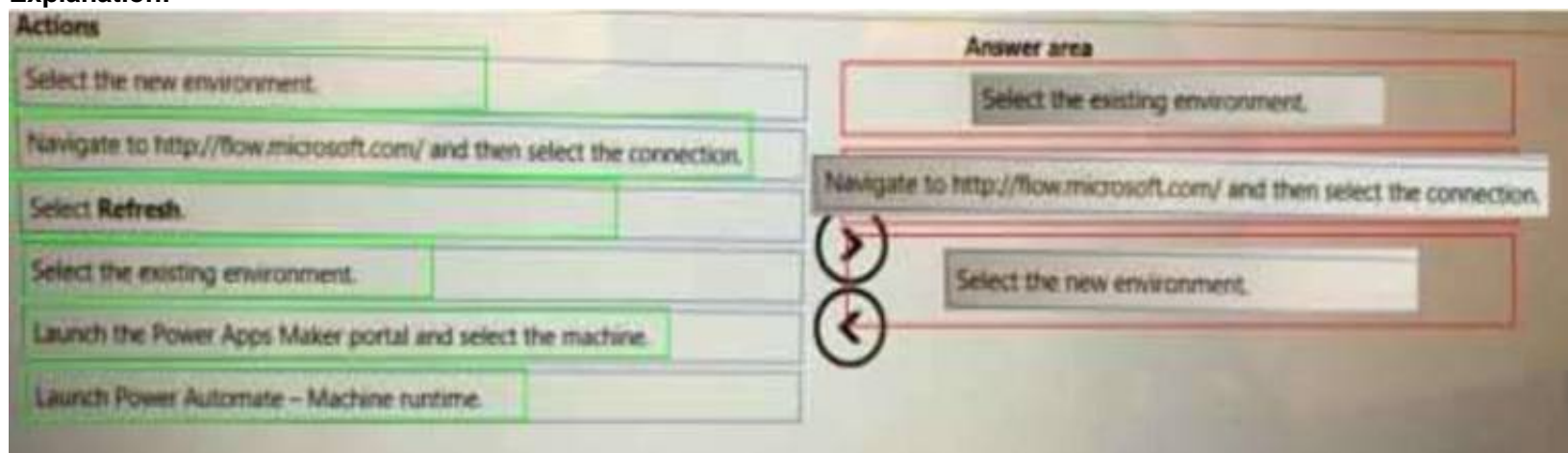

NEW QUESTION 9

- (Exam Topic 3)

You are creating a solution that will use a Choice field for approvals.

You need to ensure that other users can use the Choice field with their Microsoft Dataverse tables.

What should you use?

- A. Environment variable
- B. Local choice
- C. Global choice

Answer: C

NEW QUESTION 10

- (Exam Topic 3)

You develop a desktop flow for a company.

You need to ensure that another user can modify the flow.

Which three actions should you perform in sequence? To answer, move the appropriate actions from the order.

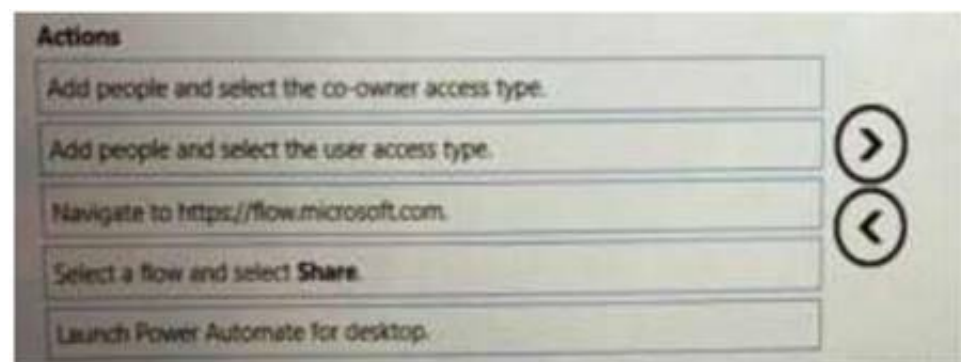

- A. Mastered
- B. Not Mastered

Answer: A

Explanation:

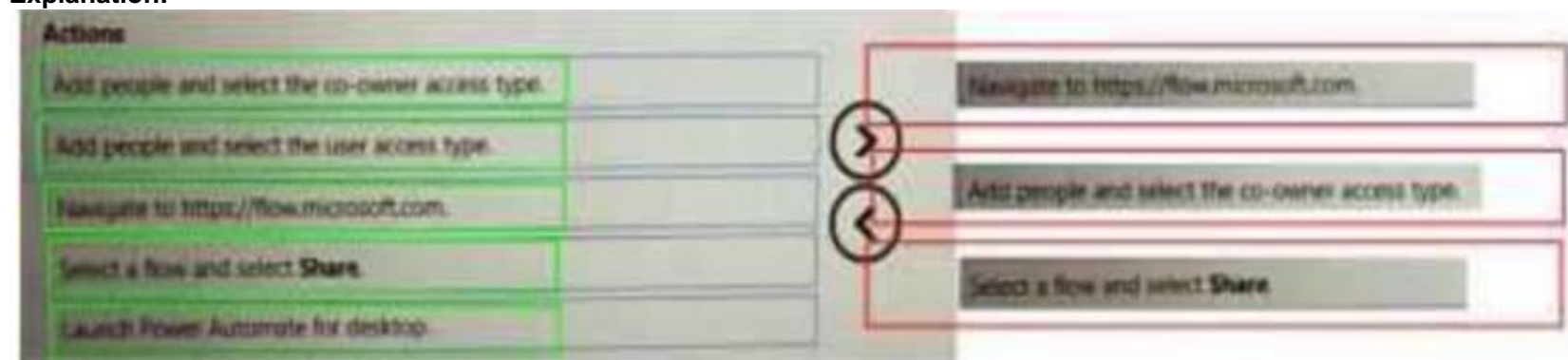

NEW QUESTION 10

- (Exam Topic 3)

A developer creates a desktop flow. You need to debug the flows.

Which debugging tools should you use? To answer, select the appropriate options in the answer area. NOTE: Each correct selection is worth one point.

Answer Area

Scenario	Debugging tool
Run each action and then pause the flow after the action completes. Open the variables pane to check a value before continuing the flow.	<div>Run delay</div> <div>Find in code</div> <div>Run from here</div> <div>Run next action</div>
Automatically stop the flow at a specific action.	<div>Pause</div> <div>Run delay</div> <div>Stop flow</div> <div>Breakpoint</div>
Define the time that the flow pauses after running each action.	<div>Run delay</div> <div>Run from here</div> <div>Run next action</div> <div>Wait for process</div>

- A. Mastered
- B. Not Mastered

Answer: A

Explanation:

Answer Area

Scenario	Debugging tool
Run each action and then pause the flow after the action completes. Open the variables pane to check a value before continuing the flow.	Run delay Find in code Run from here Run next action
Automatically stop the flow at a specific action.	Pause Run delay Stop flow Breakpoint
Define the time that the flow pauses after running each action.	Run delay Run from here Run next action Wait for process

NEW QUESTION 12
- (Exam Topic 3)
You create the following flows:

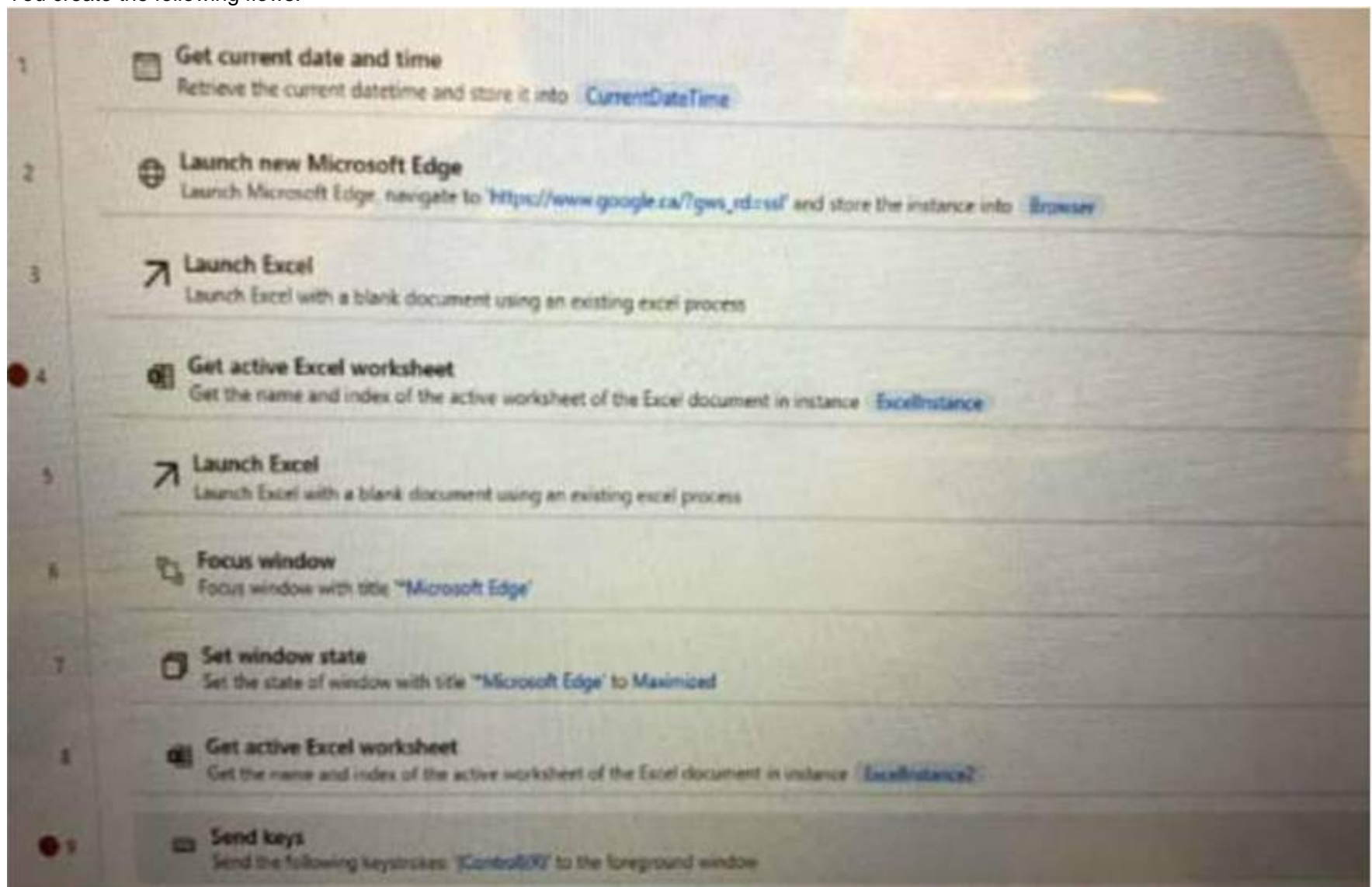

Questions	Response
Which line contains a breakpoint?	1 2 3 4 5
To which window does the action at step 9 send keystrokes?	the Edge window launched in step 2 the Excel instance launched in step 3 the Excel instance launched in step 4

- A. Mastered
- B. Not Mastered

Answer: A

Explanation:

Answer Area

Questions

Which line contains a breakpoint?

To which window does the action at step 9 send keystrokes?

Response

1

2

3

4

5

the Edge window launched in step 2

the Excel instance launched in step 3

the Excel instance launched in step 4

NEW QUESTION 14

- (Exam Topic 3)

You are preparing to create a cloud flow that queries data from a SharePoint list. You must use different SharePoint lists for the test and production environments. You need to configure the flow to select the correct SharePoint list for the environment where you deploy the flow. Which five actions should you perform in sequence? To answer, move the appropriate actions from the list of actions to the answer area and arrange them in the correct order.

Actions

Create new cloud flow in a solution and add a Get items action.

Choose a SharePoint site and list from available environmental variables.

In the solution, create a connection reference to SharePoint list.

Enter custom values for the target SharePoint site and list.

Create an environment variable where Data Type equals Data source and Parameter Type equals List.

Create an environment variable where Data Type equals Data source and Parameter Type equals Site.

Manually enter the names for the SharePoint site and list.

Select the target SharePoint site and list from a list of displayed values.

- A. Mastered
- B. Not Mastered

Answer: A

Explanation:

Actions

Create new cloud flow in a solution and add a Get items action.

Choose a SharePoint site and list from available environmental variables.

In the solution, create a connection reference to SharePoint list.

Enter custom values for the target SharePoint site and list.

Create an environment variable where Data Type equals Data source and Parameter Type equals List.

Create an environment variable where Data Type equals Data source and Parameter Type equals Site.

Manually enter the names for the SharePoint site and list.

Select the target SharePoint site and list from a list of displayed values.

Create new cloud flow in a solution and add a Get items action.

Create an environment variable where Data Type equals Data source and Parameter Type equals List.

Create an environment variable where Data Type equals Data source and Parameter Type equals Site.

Manually enter the names for the SharePoint site and list.

Select the target SharePoint site and list from a list of displayed values.

NEW QUESTION 17

- (Exam Topic 3)

A company has an unattended cloud flow solution. The solution includes a desktop flow that runs on a virtual machine. The company reports that the cloud flow processes more transactions per day than the planned capacity. You need to scale the solution to keep up with demand. Which four actions should you perform in sequence? To answer, move the appropriate actions from the list of actions to the answer area and arrange them in the correct order.

Actions

Provision virtual machines.

Register the machines to the correct environment by using flow.microsoft.com.

Add the machines to a machine group.

Register the machines to the correct environment by using the machine runtime application.

Update the machine connections to target the machine group in the cloud flow.

Update the machine connections to target the machine group in the desktop flow.

>

<

Answer Area

>

<

- A. Mastered
- B. Not Mastered

Answer: A

Explanation:

Actions

Provision virtual machines.

Register the machines to the correct environment by using flow.microsoft.com.

Add the machines to a machine group.

Register the machines to the correct environment by using the machine runtime application.

Update the machine connections to target the machine group in the cloud flow.

Update the machine connections to target the machine group in the desktop flow.

>

<

Answer Area

Update the machine connections to target the machine group in the cloud flow.

Provision virtual machines.

Add the machines to a machine group.

Update the machine connections to target the machine group in the desktop flow.

>

<

NEW QUESTION 22

- (Exam Topic 3)
You are creating a cloud flow that will use two Update Row actions to interact with Microsoft Dataverse. Neither of these actions are dependent on each other. You must minimize the amount of processing time required to complete the flow. You need to implement the actions in the cloud flow.
Solution: Create a switch condition. Does the solution meet the goal?

- A. Yes
- B. No

Answer: B

NEW QUESTION 24

- (Exam Topic 3)
You are designing an automation that processes information from documents attached to emails. You need to extract data from the attachments and insert the data into a custom Microsoft Dataverse table. Which five actions should you perform in sequence?
To answer, move the appropriate actions from the list of actions to the answer

Actions

Create a collection and add documents to the collection.

Create an object detection model.

Use the model in a desktop flow.

Create a custom form processing model.

Train and publish a model.

Add extracted data to the Microsoft Dataverse table.

Use the model in a cloud flow.

- A. Mastered
- B. Not Mastered

Answer: A

Explanation:

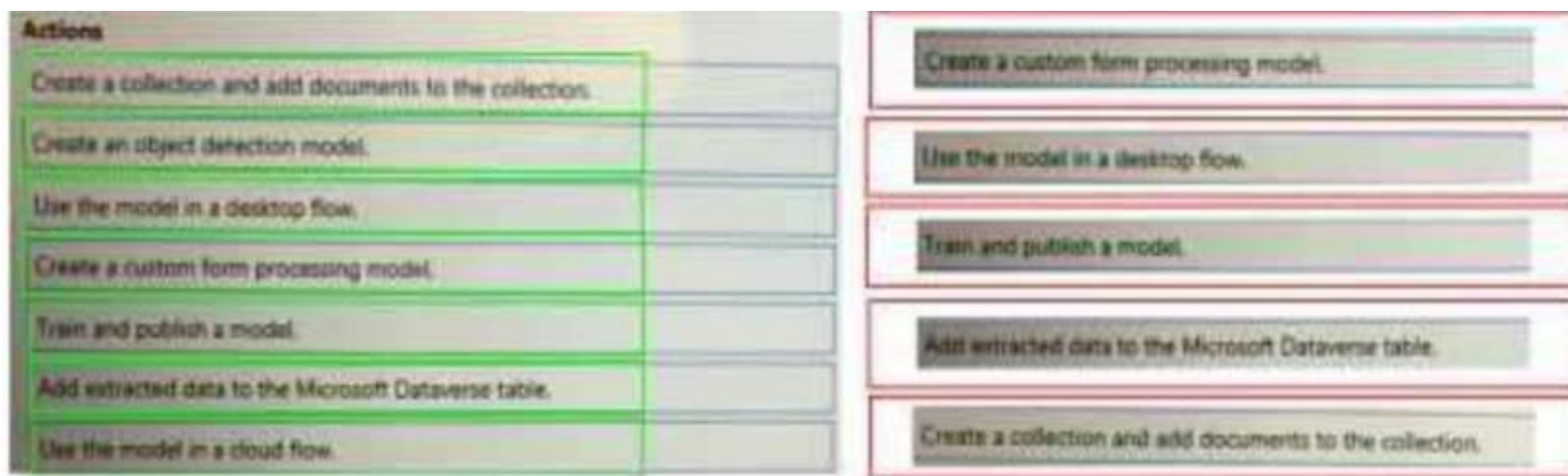

NEW QUESTION 26

- (Exam Topic 3)

You must create new flows within a solution and import existing flows into the solution. You need to configure the solution.

Which three actions can you perform? Each correct answer presents a complete solution. NOTE: Each correct selection is worth one point.

- A. Create the flows within the solution to automatically create connection references.
- B. Add credential information to each connection reference.
- C. Modify each trigger and action when you add a flow into the solution to use connection references
- D. Select connections for connection references when you import solutions into an environment
- E. Add an existing connection reference into the solution in the same environment.

Answer: ADE

NEW QUESTION 28

- (Exam Topic 3)

You plan to use a cloud flow.

The flow must be contained within a solution. You need to add the cloud flow to a solution.

Solution: Create an instant cloud flow outside of a solution. Add the cloud flow into a new unmanaged solution. Does the solution meet the goal?

- A. Yes
- B. No

Answer: A

NEW QUESTION 30

- (Exam Topic 3)

You have an automation solution that uses a desktop flow. The flow reads data from a file that is stored on a user's machine and writes the data to an application. You import the solution to an environment that is connected to another user's machine.

The user reports that the flow fails. An alert indicates that the path to a file does not exist. You confirm that the file is present on the user's desktop. You need to resolve the issue. What should you do?

- A. Move the file to the user's documents folder.
- B. Move the file to the user's OneDrive storage.
- C. Delete and recreate the file.
- D. Change the location of the file to a specific path that is not dependent on the signed-in user.

Answer: A

NEW QUESTION 33

- (Exam Topic 3)

You develop automation solutions for a company.

When a new record is added to a Microsoft Dataverse table, the solution must add the contents of the record to a Microsoft Word Online (Business) template The solution must convert the template to a PDF document and email the PDF document to a stakeholder.

You need to design the solution.

Which three actions should you perform? Each correct answer presents part of the solution. NOTE: Each correct selection is worth one point.

- A. Use the Populate a Microsoft Word Online (Business) template action in a desktop flow.
- B. Create a cloud flow that uses the When a row is added or modified trigger in Microsoft Dataverse.
- C. Use the Populate a Microsoft Word Online (Business) template action in a cloud flow.
- D. Use the Convert Word Document to PDF and Send an email actions in a cloud flow.
- E. Use the Convert Word Document to PDF and Send an email actions in a desktop flow.

Answer: ABE

NEW QUESTION 36

- (Exam Topic 3)

You are automating a form on a website. The website uses the following HTML markup to define each field on the form:

```
<div _ngcontent-cl="" class="col s6 m6 l6">
  <div class="ng-invalid ng-dirty ng-touched">
    <label>Field1</label><input ng-reflect-name="labelField1" class="ng-pristine ng-invalid ng-touched">
  </div>
</div>
```

The label for each field is unique in the form. You need to write data to the form.
For each of the following statements, select Yes if the statement is true. Otherwise, select No. NOTE: Each correct selection is worth one point.

Answer Area

Statement	Yes	No
You configure the following selector: <code>input[ng-reflect-name="labelField1"]</code> The automation will add data to the form.	<input type="radio"/>	<input type="radio"/>
You configure the following selector: <code>div:has(label:contains("Field1")) > input</code> The automation will add data to the form.	<input type="radio"/>	<input type="radio"/>
You add the Run JavaScript function on web page action to the flow: <pre>function ExecuteScript() { \$("div:contains('Field1') > input") .val("Field's 1 value") }</pre> The action adds data to the form.	<input type="radio"/>	<input type="radio"/>

- A. Mastered
- B. Not Mastered

Answer: A

Explanation:

Answer Area

Statement	Yes	No
You configure the following selector: <code>input[ng-reflect-name="labelField1"]</code> The automation will add data to the form.	<input checked="" type="radio"/>	<input type="radio"/>
You configure the following selector: <code>div:has(label:contains("Field1")) > input</code> The automation will add data to the form.	<input checked="" type="radio"/>	<input type="radio"/>
You add the Run JavaScript function on web page action to the flow: <pre>function ExecuteScript() { \$("div:contains('Field1') > input") .val("Field's 1 value") }</pre> The action adds data to the form.	<input type="radio"/>	<input checked="" type="radio"/>

NEW QUESTION 38

- (Exam Topic 3)

A company has a business-critical desktop flow that runs on a single machine. The number of daily runs for the flow has significantly increased recently. Users report that the time required for the flow to complete is no longer acceptable. You need to scale the solution. Which four actions should you perform in sequence? To answer, move the appropriate actions from the list of actions to the answer area and arrange them in the correct order.

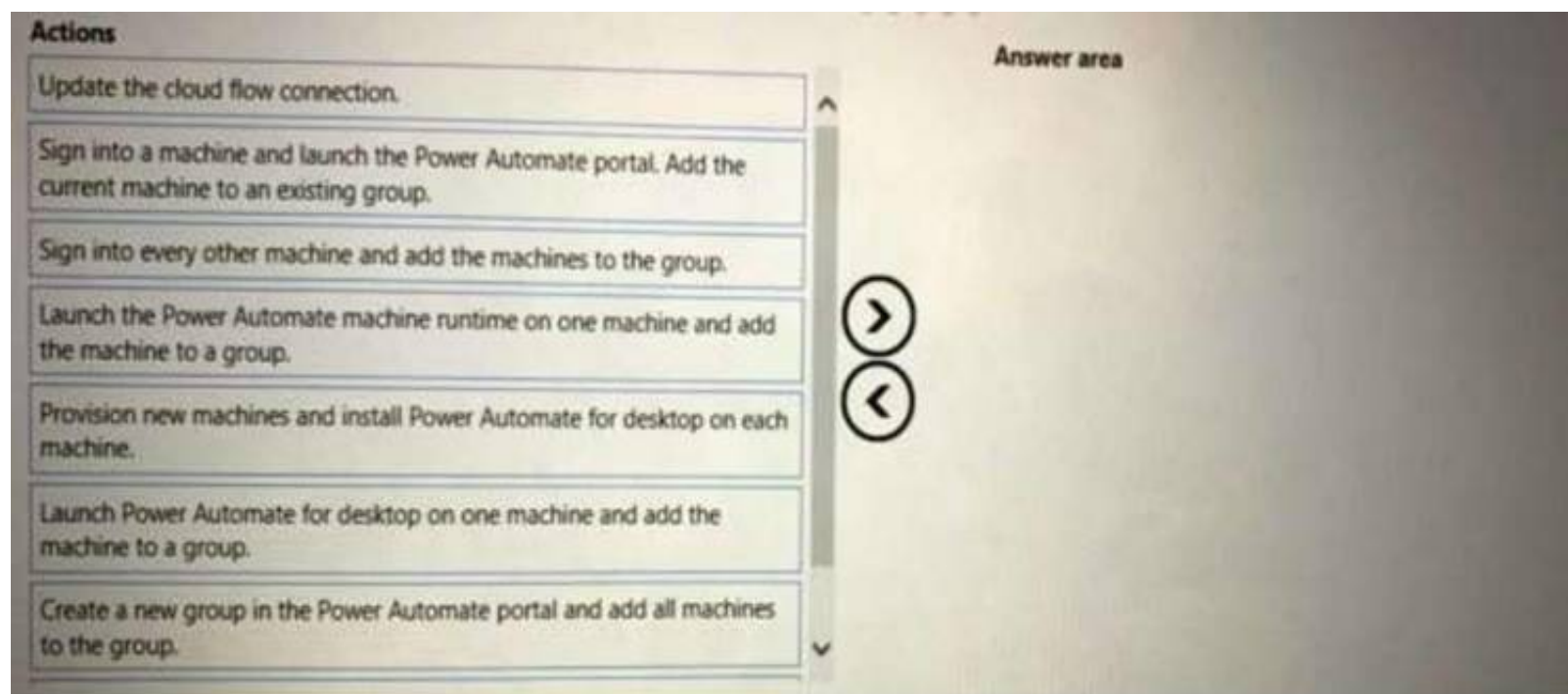

- A. Mastered
- B. Not Mastered

Answer: A

Explanation:

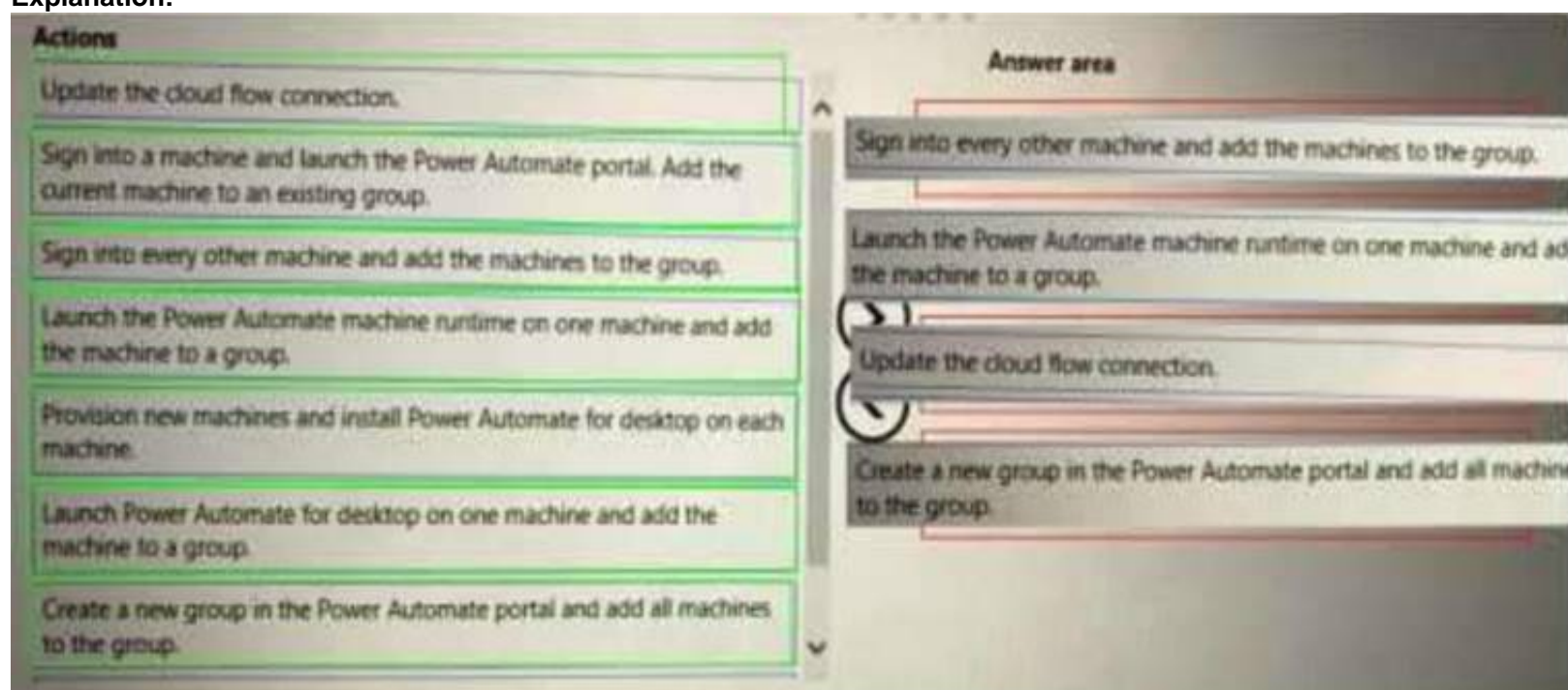

NEW QUESTION 41

- (Exam Topic 3)

You are developing an RPA solution that requires browser automation. You are testing the flow. You observe that the flow does not interact with web page elements in Microsoft Edge. You need to troubleshoot the issue. What should you do?

- A. Enable error handling on the action to retry on failure.
- B. Ensure the UI flows/Selenium extension is downloaded and enabled in Microsoft Edge.
- C. Open Power Automate machine runtime and select Troubleshoot
- D. Ensure the Power Automate for desktop browser extension is downloaded and enabled in Microsoft Edge.

Answer: A

NEW QUESTION 42

- (Exam Topic 3)

You are creating a cloud flow that will use two Update Row actions to interact with Microsoft Dataverse. Neither of these actions are dependent on each other. You must minimize the amount of processing time required to complete the flow. You need to implement the actions in the cloud flow.

Solution: Create two sequential Update Row actions. Does the solution meet the goal?

- A. Yes
- B. No

Answer: A

NEW QUESTION 44

- (Exam Topic 3)

You develop a Microsoft Power Platform solution for a client.

You must test the solution in a user acceptance testing (UAT) environment before deploying the solution to production. You must ensure that the configurations for the UAT and production environments are identical. You must minimize administrative effort.

You need to ensure that the environments are identical. Which Microsoft Power Platform feature should you use?

- A. Copy environment
- B. Edit environment properties
- C. Move environment
- D. Reset environment
- E. Restore environment

Answer: AB

NEW QUESTION 49

- (Exam Topic 3)

You plan to create a Microsoft Visio process diagram.

You need to create the diagram and then export the diagram as a Power Automate flow.

Which five actions should you perform in sequence? To answer, move the appropriate actions from the list of actions to the answer area and arrange them in the correct order.

Actions

Create the diagram by using BPMN shapes.

Create the diagram by using standard flowchart shapes.

Name the flow and select **Create Flow**.

Map shapes to flow actions.

Select **Prepare to Export** in the toolbar.

Select **Export to Flow**.

Answer Area

>

<

- A. Mastered
- B. Not Mastered

Answer: A

Explanation:

Actions

Create the diagram by using BPMN shapes.

Create the diagram by using standard flowchart shapes.

Name the flow and select **Create Flow**.

Map shapes to flow actions.

Select **Prepare to Export** in the toolbar.

Select **Export to Flow**.

Answer Area

Select **Prepare to Export** in the toolbar.

Create the diagram by using standard flowchart shapes.

Name the flow and select **Create Flow**.

Create the diagram by using BPMN shapes.

Map shapes to flow actions.

NEW QUESTION 51

- (Exam Topic 3)

You are developing an automation solution for a bank. The solution will use a cloud flow and a desktop flow.

The cloud flow retrieves sensitive information from Azure Key Vault and must pass the information to the desktop flow.

You configure a Get secret action as shown in the Get secret exhibit. (Click the Get Secret tab.)

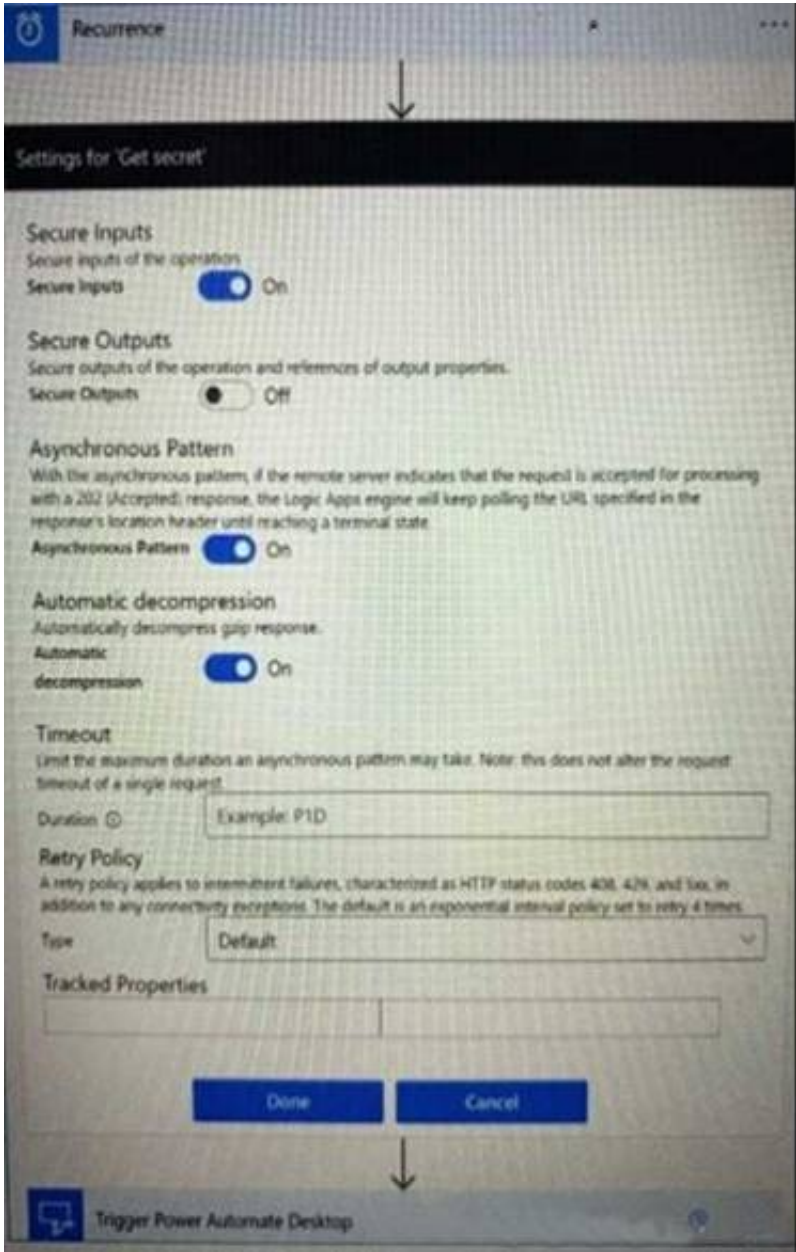

You configure the desktop flow as shown in the Desktop flow exhibit. (Click the Desktop flow tab.)

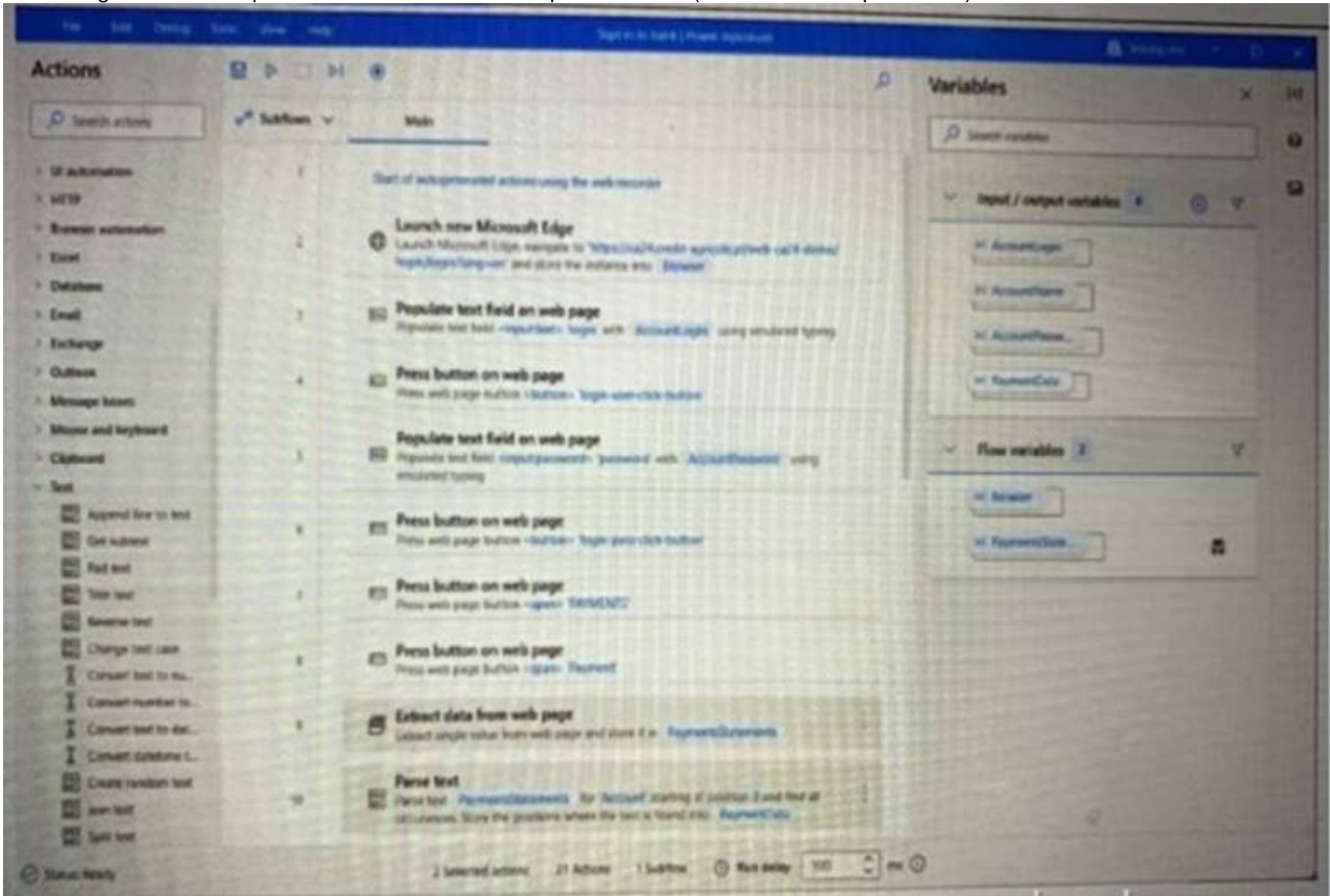

You need to ensure that no one can preview sensitive information by viewing the cloud flow or desktop flow run details.
For each of the following statements, select Yes if the statement is true. Otherwise, select No. NOTE: Each correct selection is worth one point.

Answer Area			
Statement		Yes	No
The Get Secret action is configured to protect sensitive data in the cloud flow.		<input type="radio"/>	<input type="radio"/>
The desktop flow is configured to protect account login and password data.		<input type="radio"/>	<input type="radio"/>
Data extracted by the desktop flow is visible to users.		<input type="radio"/>	<input type="radio"/>

- A. Mastered
- B. Not Mastered

Answer: A

Explanation:

Answer Area			
Statement		Yes	No
The Get Secret action is configured to protect sensitive data in the cloud flow.		<input checked="" type="radio"/>	<input type="radio"/>
The desktop flow is configured to protect account login and password data.		<input type="radio"/>	<input checked="" type="radio"/>
Data extracted by the desktop flow is visible to users.		<input type="radio"/>	<input checked="" type="radio"/>

NEW QUESTION 56

.....

THANKS FOR TRYING THE DEMO OF OUR PRODUCT

Visit Our Site to Purchase the Full Set of Actual PL-500 Exam Questions With Answers.

We Also Provide Practice Exam Software That Simulates Real Exam Environment And Has Many Self-Assessment Features. Order the PL-500 Product From:

<https://www.2passeasy.com/dumps/PL-500/>

Money Back Guarantee

PL-500 Practice Exam Features:

- * PL-500 Questions and Answers Updated Frequently
- * PL-500 Practice Questions Verified by Expert Senior Certified Staff
- * PL-500 Most Realistic Questions that Guarantee you a Pass on Your FirstTry
- * PL-500 Practice Test Questions in Multiple Choice Formats and Updatesfor 1 Year